

HD-100

OWNER'S MANUAL

DIGITAL DRUM SET



Millenium

Thank you for purchasing this digital drum set. It has been developed to act and play like an acoustic drum set but with greater ease. Before you use your new instrument, we recommend you to read through this entire manual, *before* you start to operate it.

Important safety instructions

For your own safety you must read through this chapter at first completely!



Risk of electrical shocks!

- Only connect the device using the mains adaptor supplied to a properly wired and earthed mains power socket providing mains voltage of 230 V ~ /50 Hz.
- Do not operate the device if the power adaptor, its cord or the mains plug is damaged.
- Never submerge the device in water. Wipe it with a slightly moistened cloth only.
- Do not expose the device to rain and never use it in a damp or wet environment. Make sure that the power adaptor or the adaptor cable never becomes wet or moist during use.
- Never subject the device to direct sunlight, excessive high temperatures or dust.
- This instrument contains digital circuitry and may cause interference if placed too close to radio or television receivers. If this occurs, move the instrument further away from the affected equipment.
- Under no circumstances may you open the housing of the device or the adaptor. Should you do so your safety would not be assured and the warranty will become void. There are no operational components whatsoever inside, only really **high voltage** that can give you a **deadly shock!**
- Do not place objects containing fluids, e.g. flower vases or beer bottles, on or near the device.
- Notice regarding disconnection from mains-power:
To completely disconnect the device from mains power, you must disconnect the adaptor from the power socket. For this reason the device should be placed in a position where unobstructed access to the power socket is assured at all times, so that in an emergency you will be able to immediately pull out the adaptor. To eliminate the risk of fire you should completely disconnect the adaptor from the power socket when the device is not going to be used.
- Always grasp the power adaptor itself. Do not pull on the cord and never touch the power adaptor with wet hands as this could result in a short circuit or an electrical shock. Do not place the device, speakers or anything else on the adaptor cord and make sure that it does not become clamped. Never tie knots in the adaptor cord and do not bind it together with other cables. Lay the adaptor cord so that no one can step on or stumble over it. A damaged power adaptor can cause a fire or an electrical shock. Check the power adaptor and its cord from time to time. Should it become damaged contact our customer service department to have it replaced.
- NEVER use the unit under the following conditions:
 - > In places subject to vibrations or bumps.
 - > In places with a temperature of over 45 °C/113 °F or less than 2 °C/35.6 °F.
 - > In places subject to excessive dryness or humidity (ideal conditions are between 35% and 80%).

Risk of fire!

- Never leave the device unattended during operation.
- Do not place open fire sources, such as candles, on the device.
- Never operate the device in the vicinity of heat sources such as cookers, heating elements or other heat producing installations.
- Before a storm and/or a thunderstorm with a risk of lightning, please disconnect the device from the electrical power source.

Risk of personal injury!

- This appliance is not intended for use by individuals (including children) with restricted physical, physiological or intellectual abilities or deficiencies in experience and/or knowledge unless they are supervised by a person responsible for their safety or receive from this person instruction in how the appliance is to be used. Children should be supervised to ensure that they do not play with the appliance.
- Provide a stable location for the device.
- Do not operate the device if it has sustained a fall or is damaged. Have the device checked or, if necessary, repaired by qualified technicians.

- Important! Never play the drums with high volume level. Listening to music with high sound pressure level, especially when using headphones, may cause permanent damage to your hearing!



Handling the unit

- Never apply excessive force to the controls, connectors or other parts of the instrument.
- Always unplug cables by gripping the plug firmly, but not pulling on the cable.
- Disconnect all cables before moving the instrument.
- To avoid damage to the instrument and other devices to which it is connected, turn the power switches of all related device OFF prior to connecting or disconnecting cables.
- Physical shocks caused by dropping, bumping, or placing heavy objects on the instrument can result in scratches and more serious damage.
- The normal function of the product may be disturbed by strong electromagnetic interference. If so, simply reset the product to resume normal operation by following the instruction manual. In case the function could not be resumed, please use the product in another location.
- ESD, fast transient and surge may cause the unit to temporarily malfunction. Then switch the device off and on again to resume normal operation.

Cleaning the unit

- Clean the unit with a dry soft cloth.
- A slightly damp cloth may be used to remove stubborn grime and dirt.
- Never use cleaners such as alcohol or thinner.
- Avoid placing vinyl object on top of the unit (vinyl can stick to and discolour the surface).

Features

- ▶ **100 drum and percussion sounds with high-grade resolution**
- ▶ **10 preset and 5 programmable sets**
- ▶ **30 built-in preset rhythms and one user rhythm**
- ▶ **Integrated metronome with 4 selectable click sounds**
- ▶ **Bass pad**
- ▶ **Including foot pedal, double zone snare pad, 3x tom pads, ride - Crash - hi-hat pad & hi-hat controller**
- ▶ **Headphones output & mix In sockets**
- ▶ **USB connection**

Table of contents

Important safety instructions.....	2
Features.....	3
The operating elements . . .	5
. . . on the top panel.....	5
. . . on the rear panel.....	6
Setup the drum set.....	7
Connect the pads and the pedal.....	7
Connect the power supply jack.....	8
Connect your audio equipment.....	8
Connect a CD player, etc.....	8
Connect headphones.....	8
Connect a MIDI and USB device.....	8
MIDI-Out format.....	9
Functions.....	10
Switch the power ON.....	10
Set the main volume.....	10
Select a drum kit.....	10
Adjust the kit volume.....	10
Select a pad voice.....	11
Adjust the pad volume.....	11
Save kit.....	11
Select a pattern.....	12
Listen to the pattern.....	12
Adjust the pattern volume.....	12
Recording.....	13
Enter the recording waiting mode.....	13
Enter recording mode.....	13
Stop recording.....	13
Drum off.....	14
Adjust the pattern tempo.....	15
Click.....	15
Select a click sound.....	15
Adjust the click volume.....	16
Factory reset.....	16
Hi-Hat control.....	16
Specifications.....	17
Voice list.....	18
Pattern list.....	19
Percussion set list.....	20
MIDI implementation chart.....	21
Disposal.....	22

The operating elements ...

... on the top panel

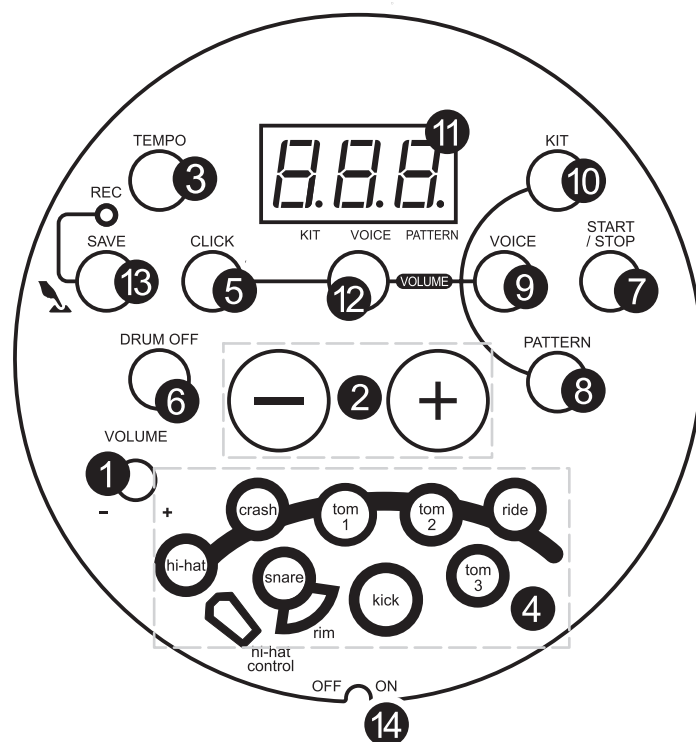

1 VOLUME:

Volume control for the headphones output. Turn it clockwise to increase the volume, turn it anticlockwise to decrease it.

2 +/-:

to adjust the currently selected parameter of the menu (KIT, voice, pattern, click value, tempo value, etc.).

3 TEMPO:

to enter the tempo adjustment mode.

4 Pad indicators:

During playing these indicators show the currently triggered pads.

5 CLICK:

to turn the metronome function on and off.

6 DRUM OFF:

to mute the drum part of a song.

7 START/STOP:

to start / stop the song playback.

8 PATTERN:

to select the pattern and for choosing the midi output format.

9 VOICE:

to select the voice.

10 KIT:

to select a drum kit.

11 3-digit LED display:

shows the parameter of the currently selected menu.

12 VOLUME:

to enter the volume adjustment mode and to separately adjust kit volume, voice volume, click volume and pattern volume.

13 SAVE/REC:

Press this button briefly to store the currently selected kit as user kit. Keep this button pressed, to start the record mode.

14 ON/OFF:

to turn the unit on and off.

... on the rear panel

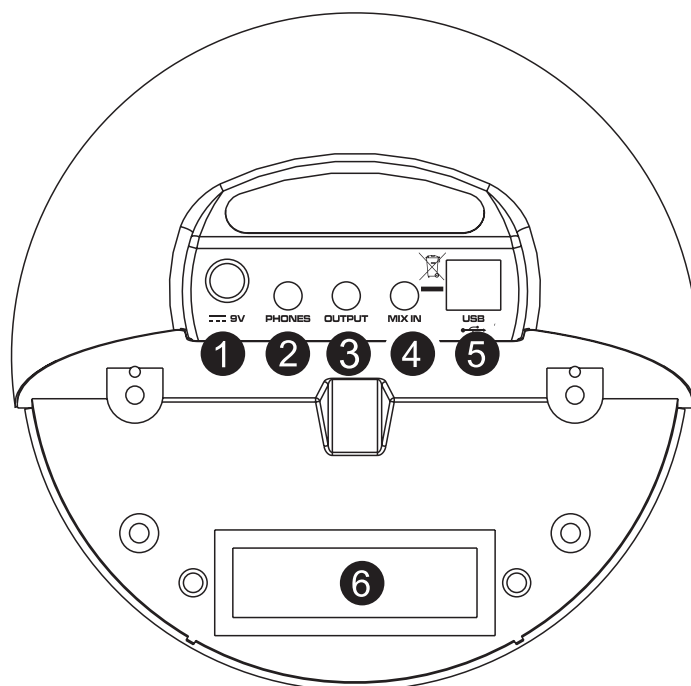

1 **9 V**

Plug in the cable of the mains adaptor here.

2 **PHONES:**

Here you can connect your headphones (not supplied).

3 **OUTPUT:**

You can connect an audio system or drum monitor to this stereo output.

4 **MIX IN:**

Connect external audio devices like MP3 or CD players to this input.

5 **USB:**

Use this socket to connect the unit to a computer (MIDI in/out via USB).

6 **Trigger input jacks:**

Connect the individual pads to these terminals.

Setup the drum set

CAUTION!

To prevent electric shock and damage to the device, make sure the power is switched OFF on the drum module and all related device before making any connection.

Connect the pads and the pedal

Connect with kick, snare, tom1~tom3, ride, crash, hi-hat, hi-hat control triggers using the cables provided. The snare drum features a stereo input and supports double triggering (increase edge triggering); cymbal (ride & crash), kick, tom, hi-hat are mono inputs that can't response edge triggering. The Hi-hat pedal also has a stereo input.

Note:

1. The voice of hitting the hi-hat pad is controlled by the hi-hat pedal. Similar to a real drum kit, the hi-hat pad functions as an 'open hi-hat' when the pedal is released. When the pedal is stepped, it functions as a 'closed hi-hat'.
2. The valid striking area of a cymbal pad (ride, crash or hi-hat) is half part of the pad on the player side, which is different from other pads.



Connect the power supply jack

Make sure the power is switched OFF, then connect the power adaptor with the DC jack on the rear panel.

1. To protect the speakers, amplifier and the drum module from damage, rotate the volume knob to the minimum volume level before switching the power ON.
2. Make sure the power is switched OFF when connecting the drum module to external devices.

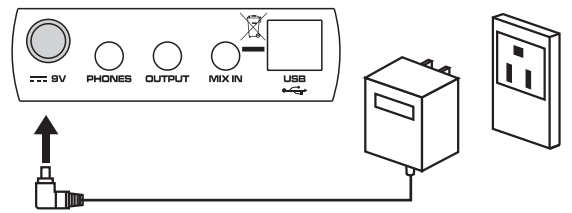

Connect your audio equipment

If you want to listen to the drum voices with an amplifier, connect that amp to the OUTPUT jacks on the rear panel.

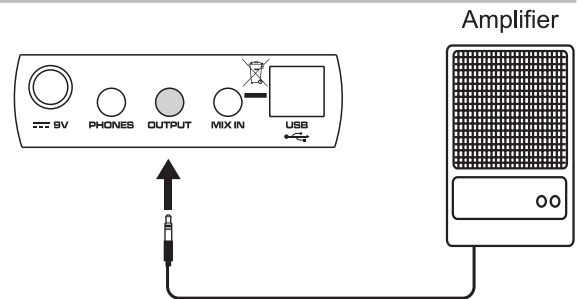

Connect a CD player, etc.

The audio output of a CD player or other audio source can be connected to the MIX IN jack on the rear panel to mix it with the sound of the drum. This function is convenient if you want to play along with a favourite song.

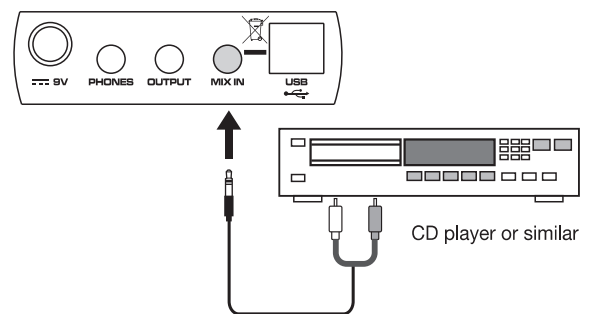

Connect headphones

An optional set of stereo headphones can be connected with the PHONES jack located on the rear of the drum module.

CAUTION! Always adjust the volume to a comfortable level! Listening to music with high sound pressure level may cause permanent damage to your hearing!

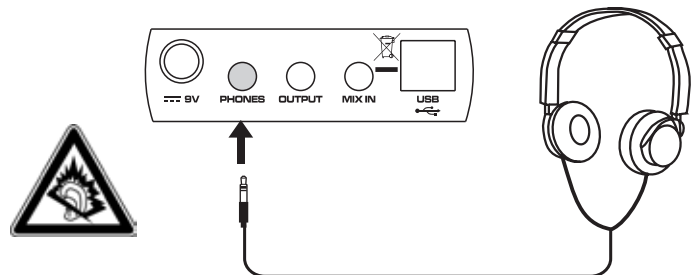

Connect a MIDI and USB device

1. Connect a computer or other USB host devices that supports USB Audio.
2. For devices with USB cable, you can choose "USB Audio Device" in the device menu of the software that transfers the midi data. The USB connection is compatible with current operating systems. A driver is not needed.
3. The drum module sends the MIDI data by hitting pads or stepping pedal through USB port. But the data of the click and song playing is not included. USB port only sends and receives MIDI information.

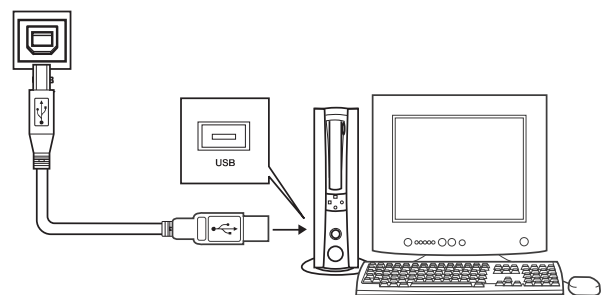

Note:

Channel 11 is set as default percussion channel.

MIDI-Out format

One of the two different MIDI output formats can be selected for the drum module: the internal format (default setting) and the GM format.

The internal format is used when the drum module works as a sound source (drum module must be connected to a computer or other module with USB host device by USB, and send midi data to another drum module. One drum module can't be connected to another drum module by USB).

The GM format is used when some other sound source is applied (drum module to other product which supports GM format), such as a computer.

If you record your own drum play to computer software with internal format, then only the drum module could recognize and playback your own song (recorded midi file) correctly.

Nevertheless, if you would like to playback your recorded midi song in any sound source device which supports GM format, we suggest you to record your own drum performance with GM format output.

In pattern selecting mode, press the PATTERN button to enter MIDI output format choice mode. The LED display shows the current MIDI output format "P-N" (default setting, internal format) or "--N" (GM format). It can be selected by pressing the +/- buttons.

If the internal format (P-N) is selected, "program change" and "note on/off" commands will be transmitted. When the GM format (--N) is selected, only 'note on/off' commands will be transmitted.

Note:

The above setting only affects the primary percussion channel. (MIDI channel 10)

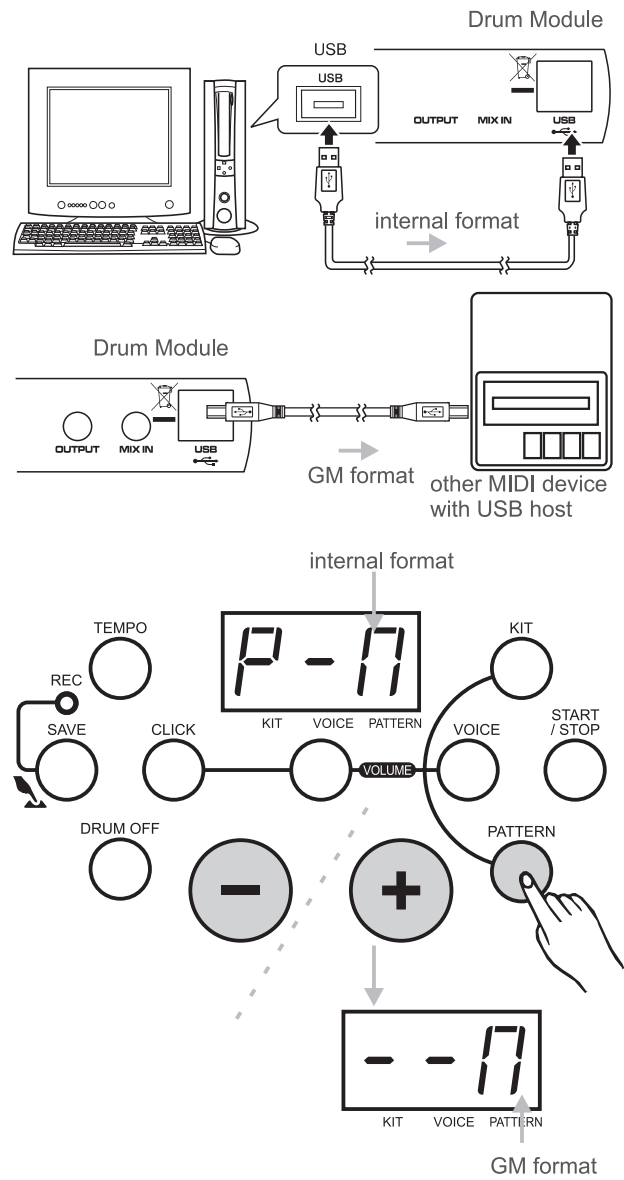

Functions

Switch the power ON

After all connections have been completed, rotate the volume knob to the left (= minimum volume level) before switching the power on.

Set the power switch to “ON” position to switch on the power. The display then shows the kit’s number and its indicator lights up.

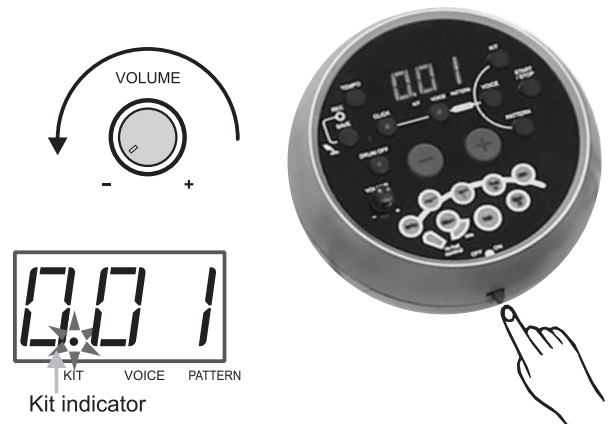

Set the main volume

While hitting a pad, gradually rotate the volume knob until a comfortable volume level is reached.



Select a drum kit

The unit comes with 10 (001-010) preset drum kits and 5 user kits (011-015).

Press the KIT button to enter KIT selecting mode, 3-digit LED displays the current KIT number and the KIT indicator lights up.

In kit selecting mode, press + or – button to choose any KIT (001-015, in cycle) as the current KIT.

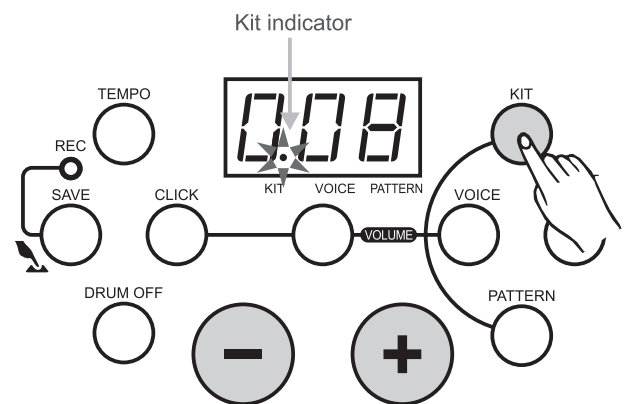

Adjust the kit volume

In KIT selecting mode, press the VOLUME button to enter volume adjusting mode, the volume indicator lights up and the 3-digit LED displays the current kit volume value. Adjust its value by pressing the +/- buttons. (0-16, not in cycle). Then press the KIT button again to enter the KIT selecting mode. The volume indicator goes out.

Please note that in recording waiting mode, the KIT volume value can be shown on the display but it can not be adjusted.

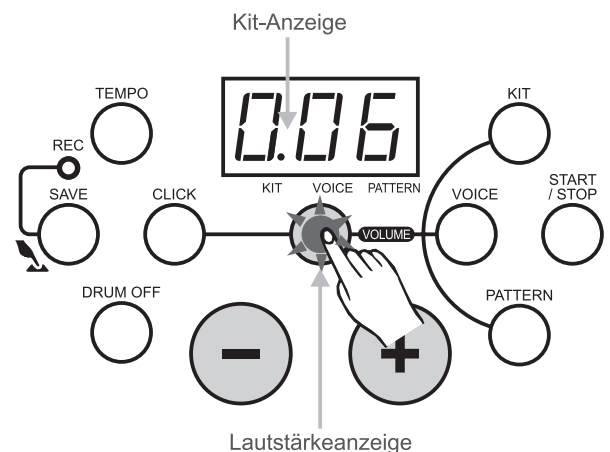

Select a pad voice

The drum module provides 108 built-in drum voices in total to choose from.

Press the VOICE button to enter pad voice selecting mode. The 3-digit LED displays the current pad voice number and the voice indicator lights up.

In the pad voice selecting mode, press +/- buttons to choose the voice of the current pad or cymbal (1-108, in cycle).

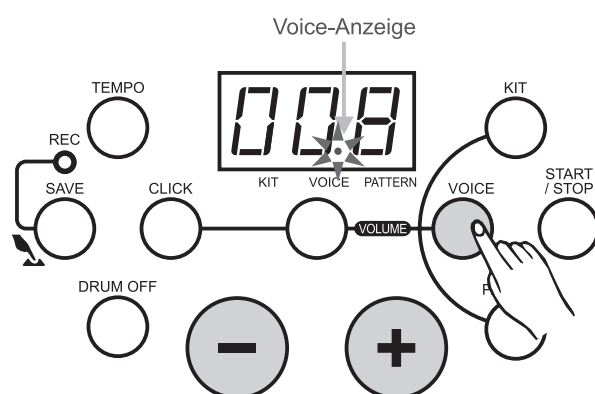

Adjust the pad volume

In voice selecting mode, press the VOLUME button to enter pad volume adjusting mode. Then the volume indicator lights up and the LED displays the current pad volume value.

Press the +/- buttons to adjust its value (0-16, not in cycle).

Press the VOICE button again to enter voice selecting mode.

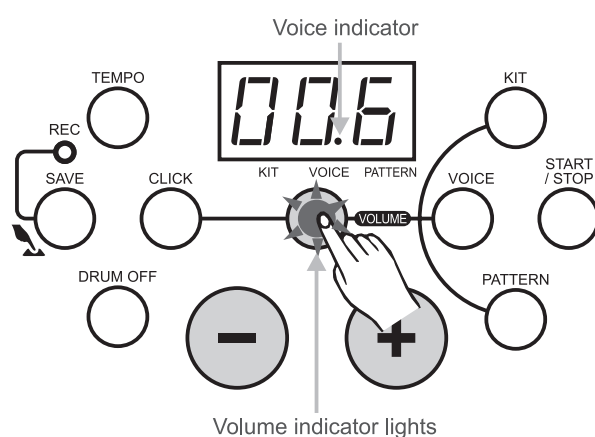

Save kit

Press the SAVE button to enter KIT saving mode. The LED displays the user KIT number to save, the KIT indicator lights up and the user KIT number flashes.

Press +/- buttons to choose the user KIT (11-15, in cycle) to save. During choosing the KIT, the user KIT number will keep flashing.

Press the SAVE button again. The current KIT setting (including all pads voice numbers and volume) is saved into the selected user KIT.

When in recording mode, this function is not available to the user.

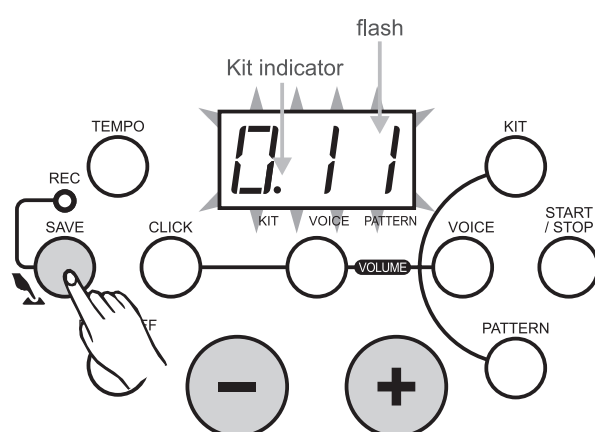

Select a pattern

The unit offers 41 built-in patterns (40 preset patterns and one user pattern).

Press the PATTERN button to enter pattern choice mode, the 3-digit LED displays the current pattern number and the pattern indicator lights up.

Press the +/- buttons to choose the current pattern number (1-41, in cycle).

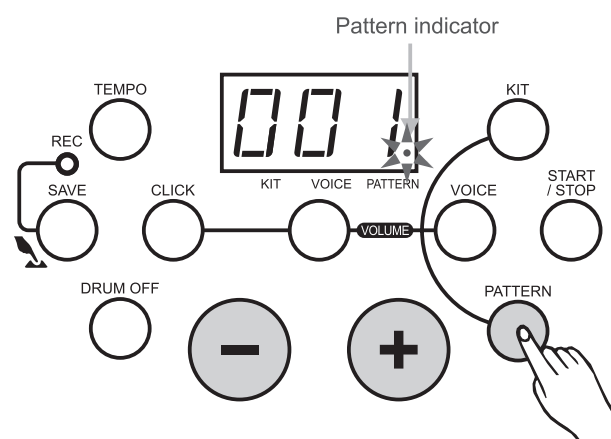

Listen to the pattern

Press the START/STOP button to start/stop pattern playing. In process of pattern playing, the click indicator flashes, which shows the beat of the playing pattern. Additionally the pad indicators light up in accompany with the variable trigger sound in process of pattern play, for easy learning and practicing. If another pattern is selected in current song playing, it will start to play at the next measure.

In pattern playing mode, press START/STOP button to stop pattern play.

Note:

The pattern and the MIDI IN use the same 16 midi channels. When you use MIDI IN to play a song, it might affect the built-in pattern playing. So you must reset the drum module.

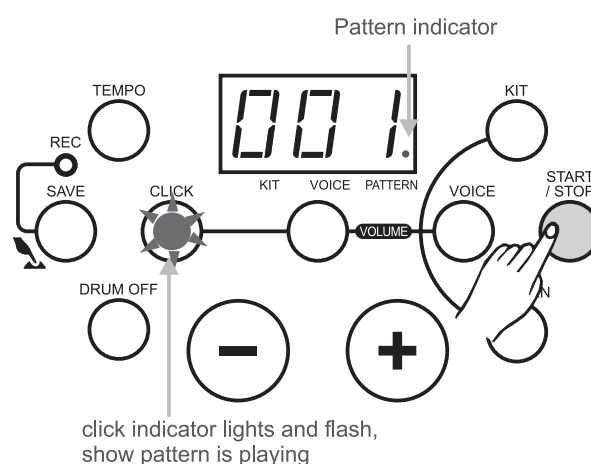

Adjust the pattern volume

In pattern choice mode, press the VOLUME button to enter pattern volume adjusting mode. The 3-digit LED displays the accompaniment volume value of current pattern (please note that the percussion part volume can not be adjusted, it just can be muted on/off by using DRUM OFF button). The volume indicator lights up, press the +/- buttons to adjust the pattern volume value (0-16, not in cycle). Then press the PATTERN button again to enter pattern choice mode.

Please note that in recording waiting mode, the pattern volume value could be shown on the display but it could not be adjusted.

Note:

Pattern volume only controls the accompaniment part volume of the pattern.

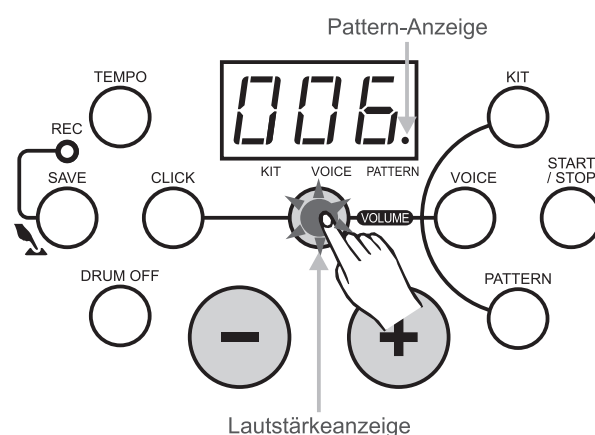

Recording

Enter the recording waiting mode

Press and hold the SAVE button for about 2 seconds, to enter user pattern recording waiting mode. The 3-digit LED displays the KIT number and the REC indicator flashes. In recording waiting mode the correspondent parameter can be adjusted.

- Adjust pattern number as accompaniment.
- Adjust tempo value.
- Adjust KIT number.
- Switch drum off status.
- Turn on/off click.

In the Recording Waiting Mode, press the PATTERN button to show the pattern (---/001~040) as accompaniment for recording. Use the +/- buttons to select the accompaniment. If "---" is selected, that means the user would like to record a solo drum part.

Note:

VOICE selecting function is not available for the user in recording waiting mode and time signature.

Enter recording mode

Press the START/STOP button or hit the pads to enter recording mode. Then the REC indicator lights all along and the 3-digit LED displays recording measures.

- During recording, the original data will be replaced with the newly recorded user pattern.
- One measure introductory beat (such as 4/4, display: -4, -3, -2, -1).
- No parameters can be adjusted during recording. Only „START/STOP“ and „CLICK“ buttons function during recording.
- The click sound will not be recorded.

Stop recording

When the recording memory is full, the recording automatically stops and the REC indicator goes out. The 3-digit LED displays 'ful', then press the START/STOP button to return to NO.41 PATTERN display.

If you press the START/STOP button during recording, the recording will stop and the REC indicator goes out. The unit then returns to NO.41 PATTERN display.

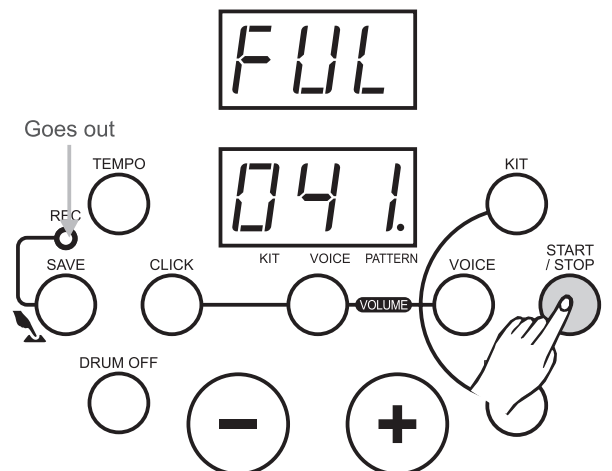
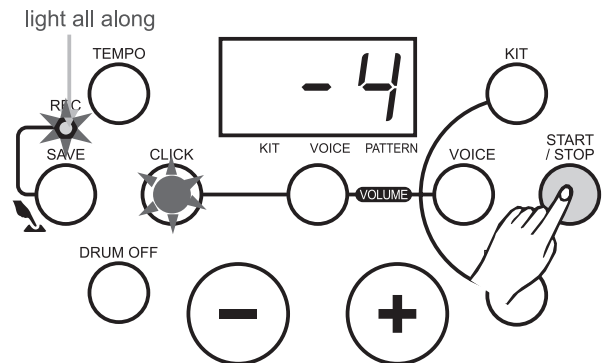
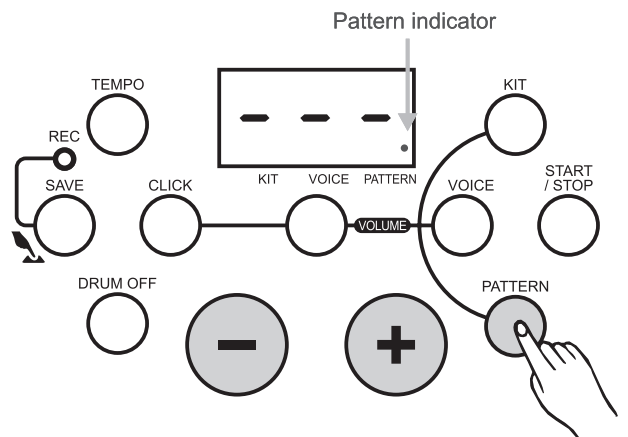
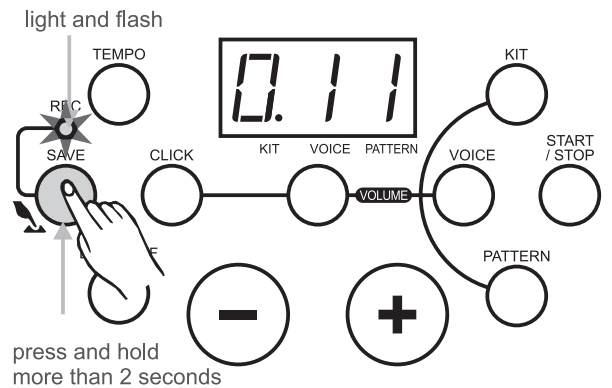

Playback User Pattern

Choose the pattern number 41, then press the START/STOP button to play user pattern.

- If there is no recording data, 3-digit LED displays “N-P”.
- The user is allowed to change pattern volume and tempo value when playing user pattern.
- No measures displayed on LED.
- The unit does not play the user pattern in cycle.
- When using the DRUM OFF button, it just mutes the drum part of the accompaniment and will not mute the recorded part.
- Pattern volume and Kit volume only control the corresponding part of the accompaniment.

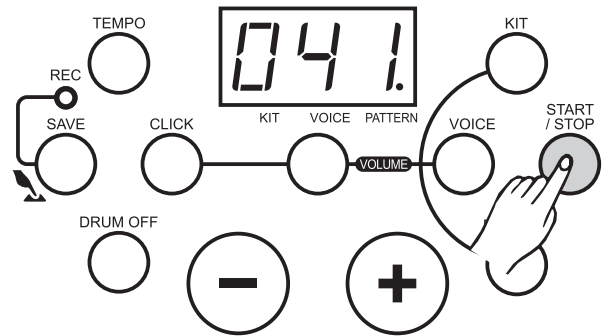

Note:

If the user selects another kit when playing back the user pattern, the recorded kit data will also be changed to the currently selected kit.

Recording notes

The recording capacity is about 5000 notes.

Quick recording

After choosing a favourite KIT and adjusting the parameter well, (includes tempo, click etc.), the user can easily press and hold the SAVE button to enter recording waiting mode, then hit the pads or press the START/STOP button to start recording.

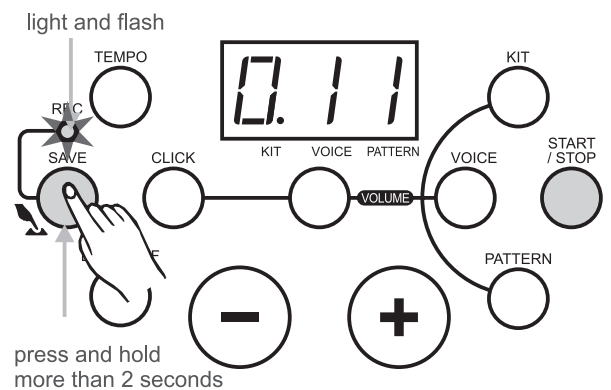

Drum off

Press the DRUM OFF button to mute on/off the drum part. If “drum off” is activated, the drum sound of the currently playing pattern will be muted and the “drum off” indicator lights up. This function is convenient for user practise.

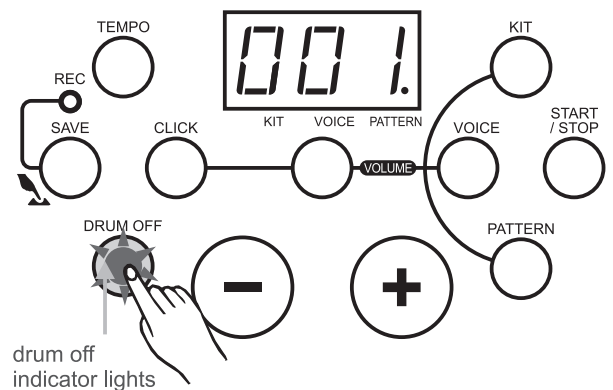

Adjust the pattern tempo

Press the TEMPO button to enter tempo adjustment mode. The 3-digit LED then temporarily displays TEMPO value.

Press the +/- buttons to change the tempo of click and pattern playing (30-280, not in cycle).

Press + and - button at the same time, to reset to the default value (the current pattern default tempo).

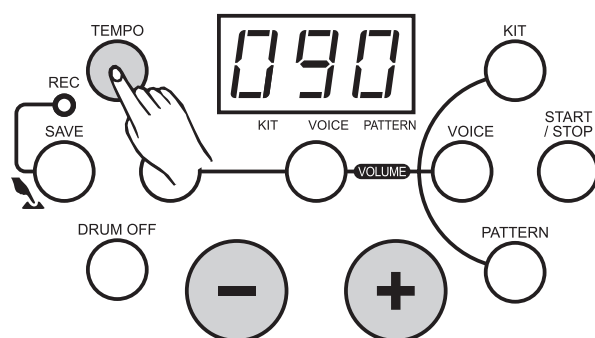

Click

Press the CLICK button to turn on/off the click function. The 3-digit LED displays the current time signature, and the click indicator lights and flash. Press the +/- buttons to change the current time signature. Press the CLICK button again to turn off the click function.

9 kinds of time signatures can be chosen (1/4, 2/4, 3/4, 4/4, 5/4, 6/4, 7/4, 3/8, 6/8).

As a pattern is playing, the click indicator automatically flashes according to the pattern beat, but the click sound will not be turned on automatically.

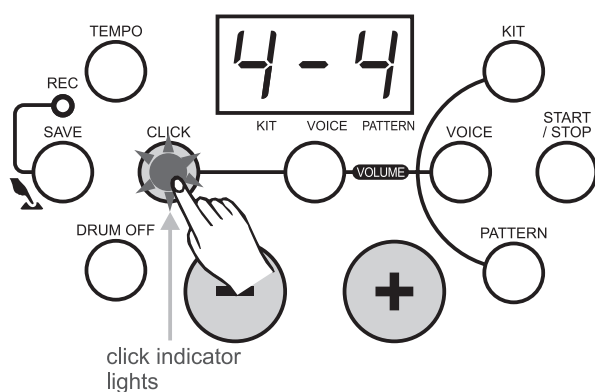

Select a click sound

Press and hold the CLICK button, then press the +/- buttons to adjust the click sound. The 3-digit LED temporarily displays the current click sound 'CLX'.

The drum module supports 4 click sounds: metronome, beep, cowbell and voice. When turning on the click, the default sound is "metronome".

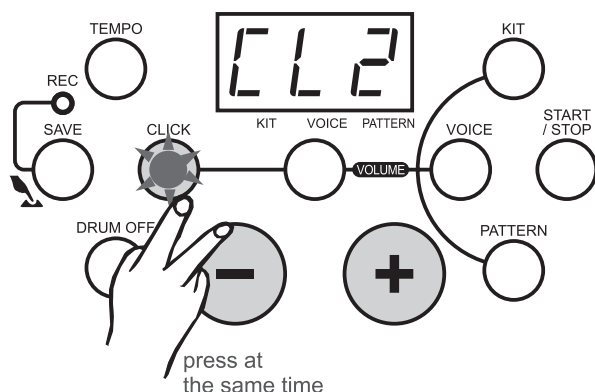

Adjust the click volume

In click time signature choice mode, press the VOLUME button to enter click volume adjusting mode. The volume indicator lights up and the 3-digit LED displays the current click volume value. Its volume value can be adjusted by pressing the +/- buttons (0-16 not in cycle).

Return to click time signature choice mode

In click volume adjusting mode, press the CLICK button to exit the volume adjusting mode and to return to the click time signature choice mode.

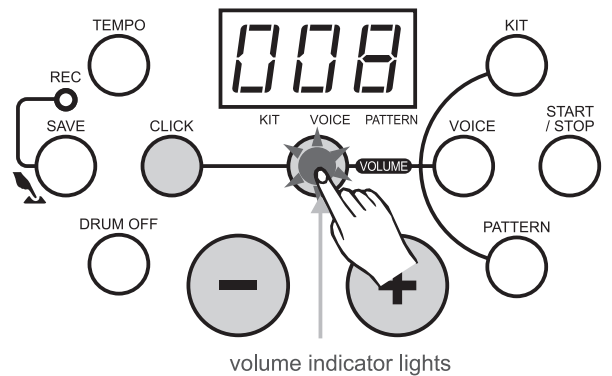

Factory reset

If you keep both + and – buttons pressed at the same time when turning on the drum module, it will be reset to the factory default settings. The following data will be replaced by the factory data:

- All users kits (include voice, volume setting).
- All recorded data.

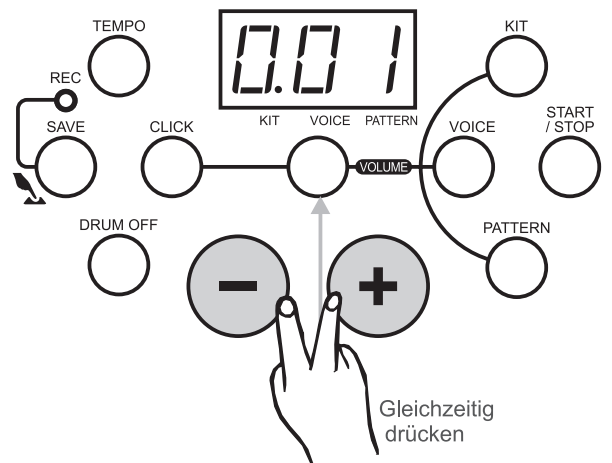

Hi-Hat control

- Open hi-hat: Strike the hi-hat without stepping the pedal.
- Closed hi-hat: Strike the hi-hat with the pedal stepped.
- Foot closed: Completely step down the pedal.
- Splash: play the hi-hat with the pedal fully stepped and then instantly releasing it.



Specifications

Drum Pads:	3 tom pads 2 cymbal pads 1 snare pad (dual trigger) 1 hi-hat control pedal 1 hi-hat 1 kick
------------	---

Voices:	108 voices
---------	------------

Drum kits:	10 preset kits 5 user kits
------------	-------------------------------

Patterns:	40 preset songs and 1 user pattern
-----------	------------------------------------

Display:	LED display
----------	-------------

Connections:	PHONES USB OUTPUT MIX IN DC POWER Hi-hat control Hi-hat Crash Ride Snare Tom 1 Tom 2 Tom 3 Kick
--------------	--

Power Supply:	AC mains adaptor (DC 9V $\overline{=}$)
---------------	--

Voice list

No. NAME

KICK

001	Standard Kick 1
002	Standard Kick 2
003	Classic Kick 1
004	Classic Kick 2
005	Rock Kick
006	Camco Kick 1
007	Camco Kick 2
008	Acoustic Kick 1
009	Acoustic Kick 2
010	Acoustic Kick 3
011	Acoustic Kick 4
012	TR606 Kick

SNARE

013	Standard Snare
014	Standard Snare Rim
015	Funk Snare
016	Funk Snare Rim
017	Funk Stick
018	Classic Snare
019	Classic Snare Rim
020	Rock Snare
021	Rock Snare Rim
022	Brush Snare
023	Brush Snare Rim
024	Camco Snare
025	Camco Snare Rim
026	TR606 Snare

TOM

027	Classic Tom 1
028	Classic Tom 2
029	Classic Tom 3
030	Classic Tom 4
031	Classic Tom 5
032	Classic Tom 6
033	Rock Tom 1
034	Rock Tom 2
035	Rock Tom 3

Preset kits and default user kits

No. NAME

001	Standard
002	Rock
003	Pop
004	Funk
005	Brush
006	Jazz
007	Table
008	Latin

No. NAME

036	Rock Tom 4
037	Rock Tom 5
038	Rock Tom 6
039	Brush Tom 1
040	Brush Tom 2
041	Brush Tom 3
042	Brush Tom 4
043	Brush Tom 5
044	Brush Tom 6
045	Camco Tom 1
046	Camco Tom 2
047	Camco Tom 3
048	Camco Tom 4
049	Camco Tom 5
050	Camco Tom 6
051	TR606 Tom 1
052	TR606 Tom 2
053	TR606 Tom 3
054	TR606 Tom 4
055	TR606 Tom 5
056	TR606 Tom 6

RIDE

057	Classic Ride
058	Rock Ride
059	Brush Ride
060	TR606 Ride

CRASH

061	Classic Crash
062	Rock Crash 1
063	Rock Crash 2
064	Brush Crash
065	China Crash
066	TR606 Crash

HI HAT

067	Classic Open Hi Hat
068	Rock Open Hi Hat
069	TR606 Open Hi Hat

No. NAME

009	TR606
010	DJ
011	User kit1 (Standard)
012	User kit2 (Rock)
013	User kit3 (Pop)
014	User kit4 (Funk)
015	User kit5 (Brush)

No. NAME

Percussions

070	Tabla 001
071	Tabla 002
072	Tabla 003
073	Tabla 004
074	Tabla 005
075	Tabla 006
076	Bongo High
077	Bongo Low
078	Conga 1
079	Conga 2
080	Conga 3
081	Timbale High
082	Timbale Low
083	Agogo High
084	Agogo Low
085	Cowbell 1
086	Cowbell 2
087	Cowbell 3
088	Cowbell 4
089	Cowbell 5
090	Cowbell 6
091	Cowbell 7
092	Cowbell 8
093	Cowbell 9
094	Cowbell 10
095	Hi Hat 001
096	Hi Hat 002
097	Hi Hat 003
098	Hi Hat 004
099	Hi Hat 005
100	Hi Hat 006
101	Hi Hat 007
102	Hi Hat 008
103	Hi Hat 009
104	Dj001
105	Dj002
106	Dj003
107	Dj004
108	Dj005

Note:

Number 001~010 are preset kits, number 011~015 are users kits.

Pattern list

<u>No.</u>	<u>PATTERN</u>	<u>No.</u>	<u>PATTERN</u>
001	Fusion1	022	Fusion2
002	Latin Jazz1	023	Jazz1
003	Funk1	024	Guitar Bossa
004	Latin Pop1	025	Break Beat
005	60's Rock	026	World1
006	Big Band1	027	Funk3
007	Drum N'Bass	028	Latin Jazz3
008	Ballad	029	Latin Pop2
009	Swing	030	Reggae1
010	Pop1	031	World2
011	Funk2	032	Latin
012	Latin Jazz2	033	Bossa
013	Pop Funk1	034	Samba2
014	Latin Rock1	035	3/4Pop
015	Big Band2	036	Pop2
016	Pop Ballad	037	Jazz2
017	Pop Funk2	038	Reggae2
018	3/4Jazz	039	Reggae3
019	Pop Bossa	040	Latin Rock2
020	Samba1	041	User Pattern
021	6/8Ballad		

Percussion set list

Standard (PC0)	Rock (PC1)	Pop (PC2)	Funk (PC3)	Brush (PC4)	Jazz (PC5)	606 (PC6)	DJ (PC7)
27 High Q	<-	<-	<-	<-	<-	<-	<-
28 Slap	<-	<-	<-	<-	<-	<-	<-
29 Scratch Push	<-	<-	<-	<-	<-	<-	<-
30 Scratch Pull	<-	<-	<-	<-	<-	<-	<-
31 Sticks	<-	<-	<-	<-	<-	<-	<-
32 Square Click	<-	<-	<-	<-	<-	<-	<-
33 Metronome Click	<-	<-	<-	<-	<-	<-	<-
34 Metronome Bell	<-	<-	<-	<-	<-	<-	<-
35 STD Kick 2	<-	<-	<-	<-	<-	<-	<-
36 STD Kick 2	Rock Kick	Pop Kick	Funk Kick	Brush Kick	Jazz Kick	TR606 Kick	<-
37 Side Stick	<-	<-	<-	<-	<-	<-	<-
38 STD Snare	Rock Snare	Pop Snare Drum	Funk Snare	Brush Snare	Jazz Snare	TR606 Snare	<-
39 Hand Clap	<-	<-	<-	<-	<-	<-	<-
40 STD Snare Rim	Rock Snare Rim	Pop Snare Rim	Funk Snare Rim	Brush Snare Rim	Jazz Snare Rim	TR606 Snare Rim	<-
41 STD Low Tom 2	Rock Low Tom 2	Pop Low Tom 2	Funk Low Tom 2	Brush Low Tom 2	Jazz Low Tom 2	TR606 Low Tom 2	<-
42 Closed Hi-Hat	<-	<-	<-	<-	<-	TR606 Closed Hi-Hat	<-
43 STD Low Tom 1	Rock Low Tom 1	Pop Low Tom 1	Funk Low Tom 1	Brush Low Tom 1	Jazz Low Tom 1	TR606 Low Tom 1	<-
44 Pedal Hi-Hat	<-	<-	<-	<-	<-	TR606 Pedal Hi-Hat	<-
45 STD Mid Tom 2	Rock Mid Tom 2	Pop Mid Tom 2	Funk Mid Tom 2	Brush Mid Tom 2	Jazz Mid Tom 2	TR606 Mid Tom 2	Dj Mix 5
46 Open Hi-Hat	<-	<-	<-	<-	<-	TR606 Open Hi-Hat	<-
47 STD Mid Tom 1	Rock Mid Tom 1	Pop Mid Tom 1	Funk Mid Tom 1	Brush Mid Tom 1	Jazz Mid Tom 1	TR606 Mid Tom 1	Dj Mix 4
48 STD Hi Tom 2	Rock Hi Tom 2	Pop Hi Tom 2	Funk Hi Tom 2	Brush Hi Tom 2	Jazz Hi Tom 2	TR606 Hi Tom 2	Dj Mix 3
49 Crash Cymbal 1	<-	<-	<-	<-	<-	TR606 Crash Cymbal1	Dj Mix 2
50 STD Hi Tom 1	Rock Hi Tom 1	Pop Hi Tom 1	Funk Hi Tom 1	Brush Hi Tom 1	Jazz Hi Tom 1	TR606 Hi Tom 1	<-
51 Standard Ride	Rock Ride	<-	<-	Brush Ride	<-	<-	Dj Mix 1
52 Chinese Cymbal	<-	<-	<-	<-	<-	<-	<-
53 Ride Bell	<-	<-	<-	<-	<-	<-	<-
54 Tambourine	<-	<-	<-	<-	<-	<-	<-
55 Splash Cymbal	<-	<-	<-	<-	<-	<-	<-
56 Cowbell	<-	<-	<-	<-	<-	<-	<-
57 Crash Cymbal 2	<-	<-	<-	<-	<-	<-	<-
58 Vibraslap	<-	<-	<-	<-	<-	<-	<-
59 Ride Cambal 2	<-	<-	<-	<-	<-	<-	<-
60 Hi Bongo	<-	<-	<-	<-	<-	<-	<-
61 Low Bongo	<-	<-	<-	<-	<-	<-	<-
62 Mute Hi Conga	<-	<-	<-	<-	<-	<-	<-
63 Open Hi Conga	<-	<-	<-	<-	<-	<-	<-
64 Low Conga	<-	<-	<-	<-	<-	<-	<-
65 High Timbale	<-	<-	<-	<-	<-	<-	<-
66 Low Timbale	<-	<-	<-	<-	<-	<-	<-
67 High Agogo	<-	<-	<-	<-	<-	<-	<-
68 Low Agogo	<-	<-	<-	<-	<-	<-	<-
69 Cabasa	<-	<-	<-	<-	<-	<-	<-
70 Maracas	<-	<-	<-	<-	<-	<-	<-
71 Short Whistle	<-	<-	<-	<-	<-	<-	<-
72 Long Whistle	<-	<-	<-	<-	<-	<-	<-
73 Short Guiro	<-	<-	<-	<-	<-	<-	<-
74 Long Guiro	<-	<-	<-	<-	<-	<-	<-
75 Claves	<-	<-	<-	<-	<-	<-	<-
76 Hi Wood Block	<-	<-	<-	<-	<-	<-	<-
77 Low Wood Block	<-	<-	<-	<-	<-	<-	<-
78 Mute Cuica	<-	<-	<-	<-	<-	<-	<-
79 Open Cuica	<-	<-	<-	<-	<-	<-	<-
80 Mute Triangle	<-	<-	<-	<-	<-	<-	<-
81 Open Triangle	<-	<-	<-	<-	<-	<-	<-
82 Shaker	<-	<-	<-	<-	<-	<-	<-
83 Jingle Bell	<-	<-	<-	<-	<-	<-	<-
84 Belltree	<-	<-	<-	<-	<-	<-	<-
85 Castanets	<-	<-	<-	<-	<-	<-	<-
86 Mute Surdo	<-	<-	<-	<-	<-	<-	<-
87 Open Surdo	<-	<-	<-	<-	<-	<-	<-

<-:Same as the left one.

MIDI implementation chart

Function		Transmitted	Recognised	Remarks
Basic Channel	Default	10 ch	1 - 16	
	Changed	X	X	
Mode	Default	X	X	
	Messages	X	X	
	Altered	*****	*****	
Note Number:		0 - 127	0 - 127	
	True voice	*****	0 - 127	
Velocity	Note on	O 99H, V=1-127	O	
	Note off	O (99H, V=0)	O	
After Touch	Key's	X	X	
	Channel's	X	X	
Pitch Bend		X	O	
Control Change	0	X	O	Bank Select
	1	X	O	Modulation
	5	X	O	Portamento Time
	6	X	O	Data Entry
	7	X	O	Volume
	10	X	O	Pan
	11	X	O	Expression
	64	X	O	Sustain Pedal
	65	X	O	Portamento ON/OFF
	66	X	O	Sostenuto Pedal
	67	X	O	Soft Pedal
	80	X	O	Reverb Program
	81	X	O	Chorus Program
	91	X	O	Reverb Level
	93	X	O	Chorus Level
120	X	O	All Sound Off	
121	X	O	Reset All Controllers	
123	X	O	All Notes Off	
Program Change		O	O	
System Exclusive		X	O	
System Common	Song Position	X	X	
	Song Select	X	X	
	Tune	X	X	
System Real Time	Clock	X	X	
	Commands	X	X	
AUX Messages	Local ON/OFF	X	X	
	All Notes OFF	X	O	
Messages	Active Sense	O	X	
	Reset	X	X	

Note 1: Reverb program vv = 00H to 07H (default 04H) **Note2:** Chorus program vv = 00H to 07H (default 02H)

00H : Room1
02H : Room3
04H : Hall2
06H : Delay

01H : Room2
03H : Hall1
05H : Plate
07H : Pan delay

00H : Chorus1
02H : Chorus3
04H : Feedback
06H : Short delay

01H : Chorus2
03H : Chorus4
05H : Flanger
07H : FB delay

Note3: Just respond 3 type of RPN 000~002.

O : YES X : NO

Disposal

Never throw the device into the regular household waste at the end of its useful life. This product is subject to the European Directive 2002/96/EC.

- Dispose of the device through an approved disposal centre or at your community waste facility.
- Observe the current existing regulations. In case of doubt contact your disposal facility.
- The packaging is certified via a dual system. Take all packaging materials to an environmentally friendly disposal facility in compliance with the local regulations.



Millenium