

SP-5100

User's Manual

STAGE PIANO

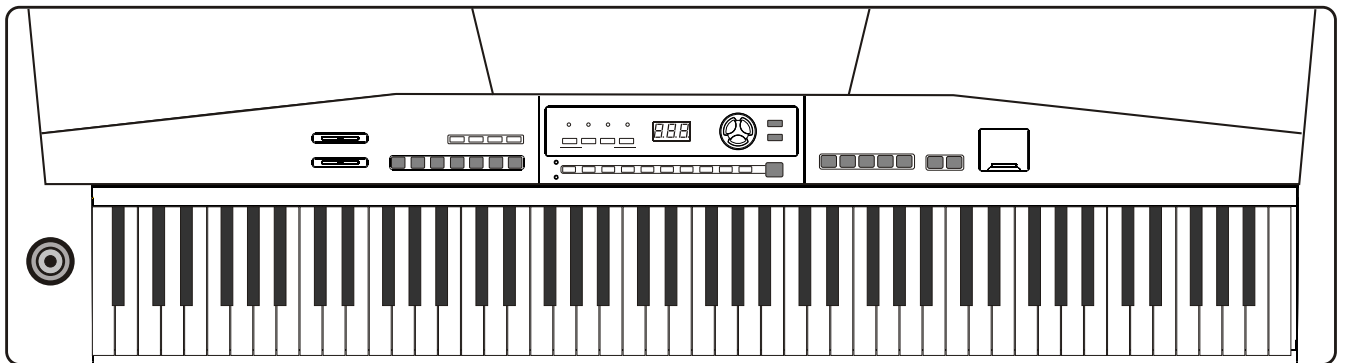

th • mann

Using the Instruction Manual

Congratulations on your purchase of this stage piano!

The piano is an user friendly piano with fabulous sound quality and advance feature such as scale practise and MIDI controller. No matter you are adult or children, you will enjoy playing the piano as it provides amazing styles for accompaniment, expressive tones, and real time record. Other features such as lesson function, variety of songs will help you better master the playing skill.

This piano also provide with SD card function, you can choose your favorite MIDI song to play; You can also backup your recording setting to SD card.

You are recommended to study this manual carefully before using the unit.

Precautions

Please read the following carefully before use:

- Do not expose the piano to high temperature, direct sunlight and excessive dusty places.
- Do not place the piano too close to other electrical appliances such as television and radio. It may cause interference.
- Do not place the piano to excessive humid area. Avoid putting container with liquid on top of the piano in order to prevent damage of the internal parts of the piano by flowing liquid.
- Always unplug AC cord by gripping the plug firmly, but not pulling on the cable.
- Do not apply excessive force to the switches and buttons.
- When the piano is not in use or in the time of thunderstorm, please disconnect the power supply.
- Avoid adjusting the volume level to the maximum or to the levels that you feel uncomfortable, we recommend you to limit the volume level to two-thirds of the max for preventing the damage of auditory sense.
- Unplug the power cable before cleaning the piano. Do not connect or disconnect the power cable with a wet hand.
- Check and clean the power plug periodically.
- To avoid damages, turn off the power switches before you disconnect the related devices from the piano.
- Clean the piano and remove the dust with a dry soft cloth or a slightly damp cloth.
- Never use cleaners such as thinner or alcohol. To prevent any damage on the surface of the LED display, please use lens cleaning tissue to clean the display.
- If the piano cable is damaged, please do not use the piano. Otherwise it may cause fire or electrical hazard.
- In case of malfunction due to improper handling the piano, please switch off and on again after 30 seconds.
- Do not attempt to disassemble or repair the piano. If the piano does not work properly, please contact the approved repairer.
- The piano should not be exposed to dripping or splashing.

Conent

Main Feature	4
General Guide	5
Control Panel	6
The Connectors	7-8
- Power Jack	7
- Headphones Jack	7
- AUX OUT Jack	7
- Sustain/Soft Jack.....	8
- MIDI IN/OUT Jack	8
Operation	9-19
- Power on & Master Volume	9
- Song	9
- Voices and Effects	10
- Metronome.....	15
- Style Control	15-16
- Record.....	17-18
- Lesson.....	18
- SD Function.....	18-19
MIDI	20-24
- MIDI Controler.....	20
- Command	21
- Channel.....	22
- Value.....	23
- MIDI OUT.....	23
- What is MIDI.....	24
Specifications	25
Voice List	26
Style List	26
Song List	27
MIDI Implementation Chart	28-29

Main Feature

Keyboard:

88 touch response keyboard with 3 touch levels.

Operation:

Use the [+] & the [-] button or direct select button to select desired function & parameters.

Voice:

20 voices in total with, 10 direct select buttons.

Style:

20 piano styles in total, use the [+] & the [-] button to select.

Song:

60 songs in total, each one has self-learning mode.

Song learning:

Use the [TRACK1 / SONG MELODY OFF] button to enter.

Record:

1 user song, include 2 record track.

SD card*:

Play midi files, save recorded data.

MIDI ctrl:

Send out midi control message

Style :

START/STOP, ACC VOL, FILL A/FILL B.

Others function buttons:

DUAL, SPLIT, REVERB/CHORUS, METRO, TRANSPOSE +/-, TOUCH, etc.

Buttons with indicator:

FILL A/FILL B, RECORD, PLAY/STOP, ACC VOL, SPLIT, DUAL, REVERB/CHORUS, TOUCH, METRO, (SD)STORE, (SD)PLAY/STOP, TRACK 1, TRACK 2, SCALE.

Pedal:

Sustain pedal, soft pedal .

Interface:

MIDI in/out, USB, Phone, Aux in/out

Note:

1. Pressing "+" and "-" together when turning on the piano will put all volume back to default setting.

2. " * ": There is a standard SD external Interface which supports the cards of 16M ~ 2G capacity. It is compatible with the file system format of the FAT 16 / 32 only

General Guide

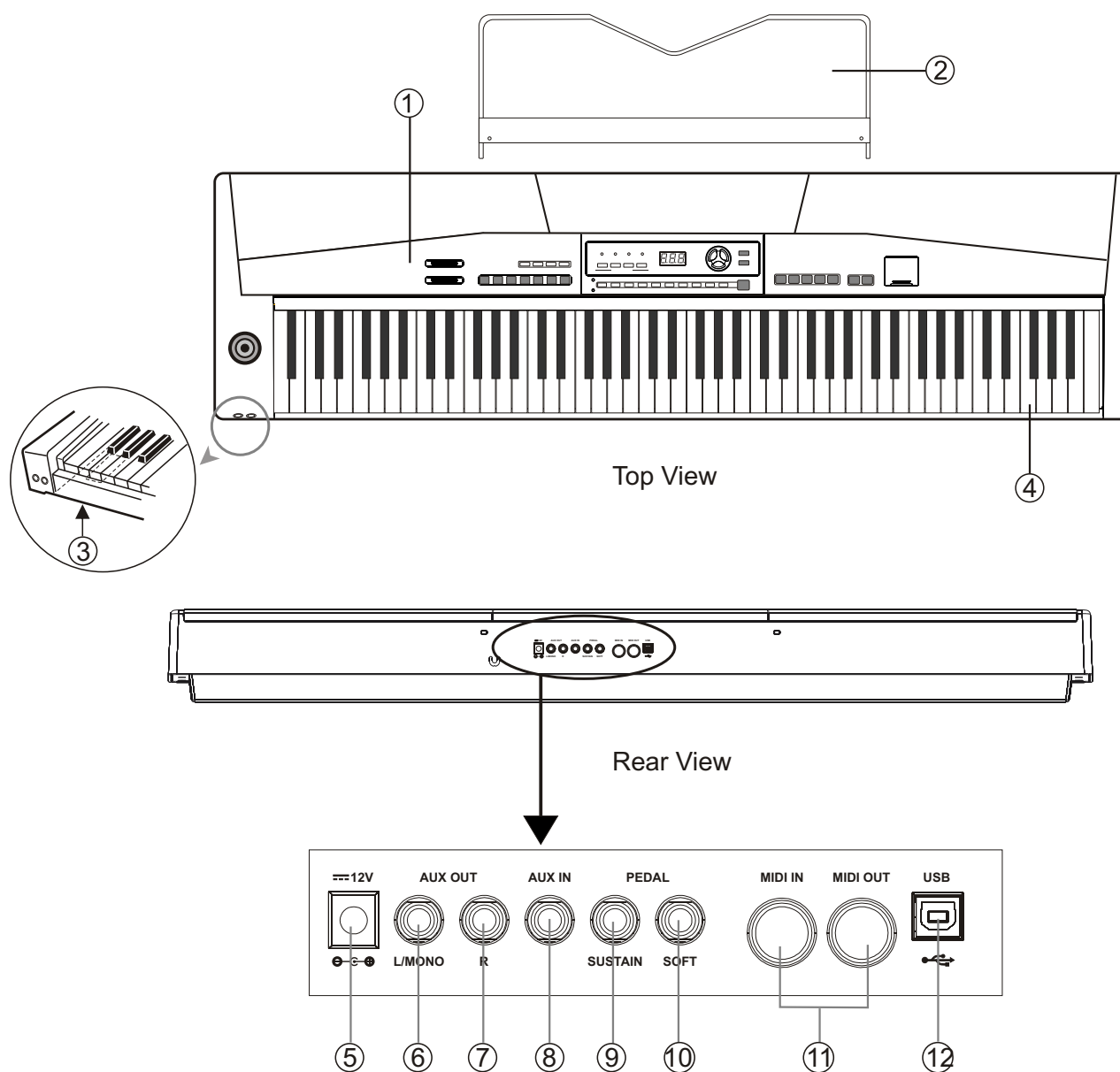

- | | |
|--------------------|----------------------|
| ① CONTROL PANEL | ⑦ AUX OUT R |
| ② MUSIC STAND | ⑧ AUX IN |
| ③ HEADPHONES JACKS | ⑨ SUSTAIN PEDAL JACK |
| ④ PIANO KEYBOARD | ⑩ SOFT PEDAL JACK |
| ⑤ POWER JACK | ⑪ MIDI IN/OUT JACKS |
| ⑥ AUX OUT L / MONO | ⑫ USB JACK |

Control Panel

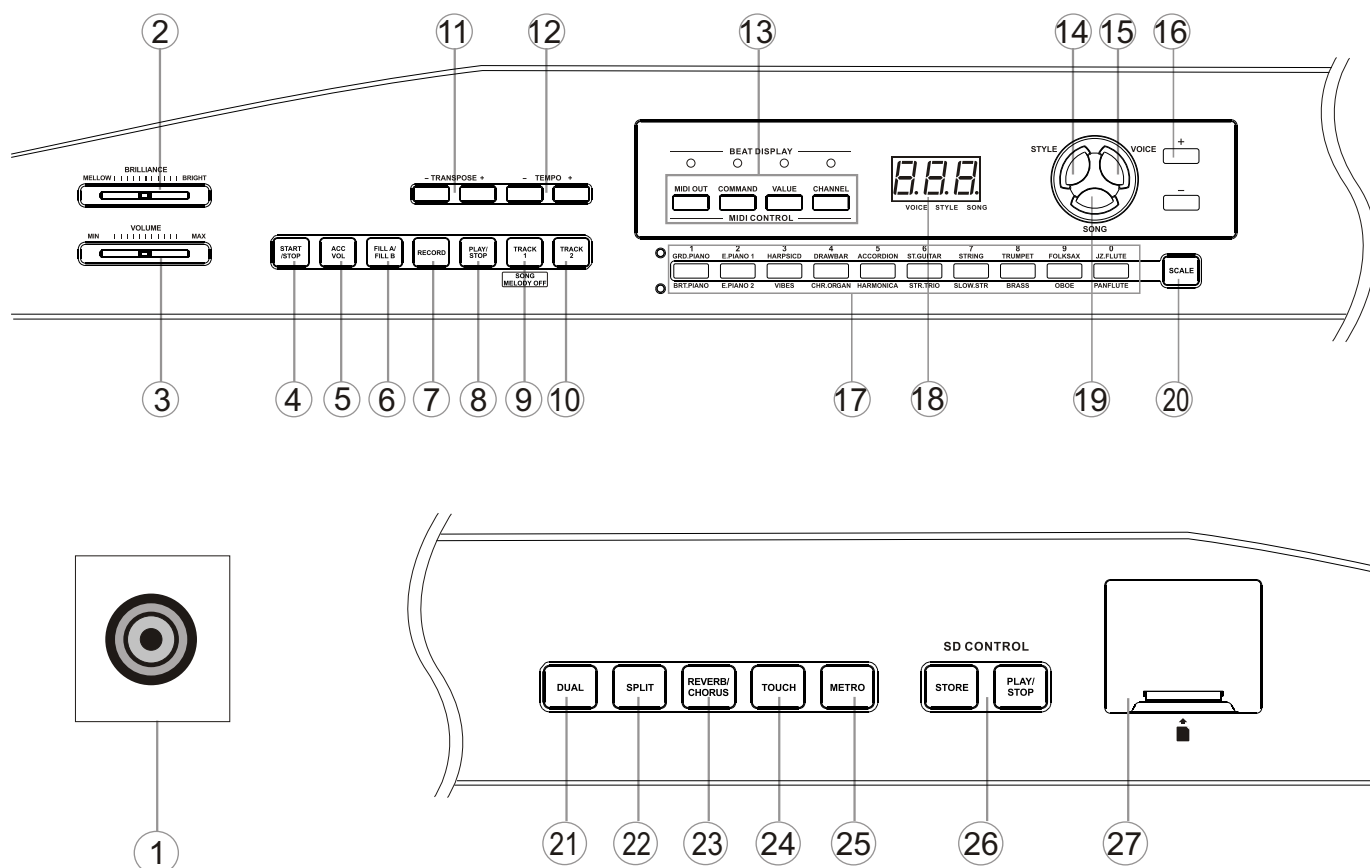

- | | |
|---------------------------|------------------------------------|
| ① POWER SWITCH | ⑭ STYLE |
| ② BRILLANCE | ⑮ VOICE |
| ③ MASTER VOLUME | ⑯ + & - |
| ④ START/STOP | ⑰ VOICE DIRECT SELECT BUTTONS |
| ⑤ ACC.VOL | ⑱ LED DISPLAY(VOICE, STYLE, SONG) |
| ⑥ FILL A/FILL B | ⑲ SONG |
| ⑦ RECORD | ⑳ SCALE |
| ⑧ PLAY/STOP | ㉑ DUAL |
| ⑨ TRACK 1/SONG MELODY OFF | ㉒ SPLIT |
| ⑩ TRACK 2 | ㉓ REVERB/CHORUS |
| ⑪ TRANSPOSE +/- | ㉔ TOUCH |
| ⑫ TEMPO +/- | ㉕ METRONOME |
| ⑬ MIDI CONTROL | ㉖ SD CONTROL |
| - MIDI OUT | - PLAY |
| - COMMAND | - STORE |
| - VALUE | ㉗ SD SLOT |
| - CHANNEL | |

Power Jack

This piano can be powered from a standard household wall outlet by using the specified AC adaptor. The power jack is located on the rear panel of the piano body.

Make sure that only the AC adaptor specified for this piano is used.

The adaptor shall be 12V DC output, and center positive type. Make sure to turn off the piano before you connect the adaptor into the AC wall outlet and the cord into the unit.

Cautions

Use of another type of adaptor creates a danger of fire and electrical shock. For safety sake, make sure to unplug the AC adaptor from the wall outlet whenever leaving the piano unattended for a long time or during a thunderstorm.

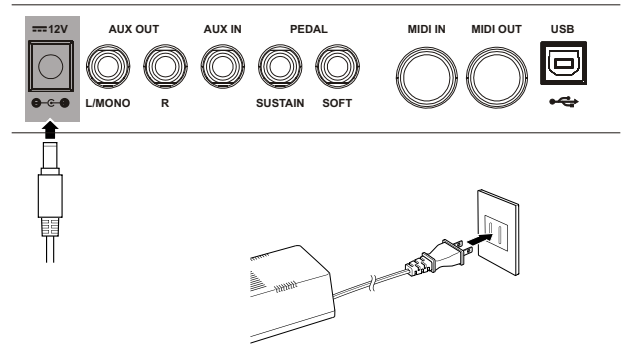

Setting Music Rest

The piano is supplied with a music rest that can be attached to the instrument by inserting it into slot at the rear of the control panel.

Please set up the music rest as shown.

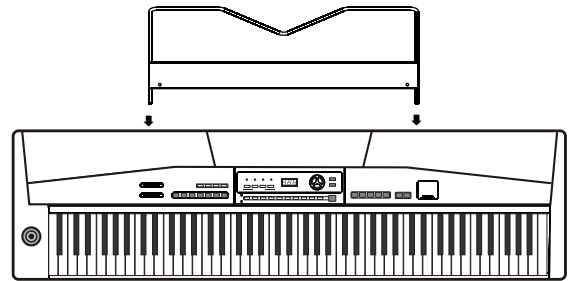

Headphones Jack

- 1 When an optional set of stereo headphones is connected with the headphones jack 2, the sound from speakers will switch off automatically resulting in only the sound from headphone to be heard.
- 2 When jack 1 is connected with the stereo headphones, the sound can be heard from both headphones and speakers of the piano.

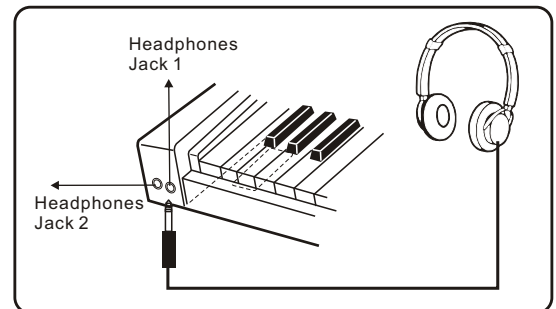

- Never use the headphone with high volume, as it may hurt your sense of hearing.
- To prevent the damage of the speakers, ensure that the volume is set to the minimum level before connecting the power and other devices.

AUX OUT Jack

When you want to listen to the voice with an amplifier, connect amplifiers to the AUX OUT L/MONO and R jacks on the rear panel. The volume is adjusted with the VOLUME button. (For monaural playback, use the L/MONO jack. For stereo playback, connect both L/MONO and R jacks.)

To avoid damaging the speakers, please ensure that volume has set to the minimum level before connecting the power and other devices.

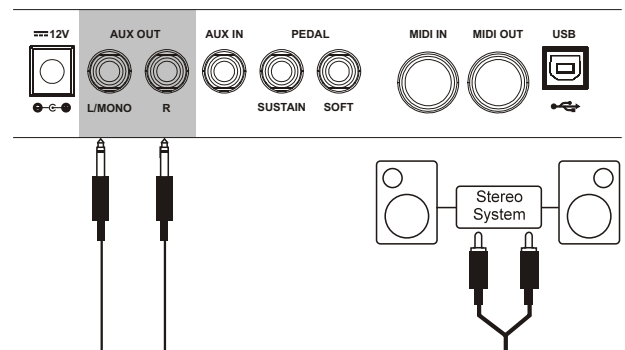

AUX IN Jack

The audio output from a CD player/iPod connected to the AUX IN jack on the rear panel can be mixed with the sound of the piano. This function is convenient when you want to play along with a favourite song. The volume of the external signal is adjusted with the **VOLUME** button.

Sustain Jack

An optional footswitch can be plugged into the **SUSTAIN** jack for sustain control. The footswitch function is like the sustain pedal on a piano.

Step the sustain pedal on to open the **SUSTAIN** function, it will apply SUSTAIN effect to the piano, then release the sustain pedal to turn off the effect.

Soft Jack

An optional footswitch can be plugged into the **SOFT** jack for soft control. Step on the soft pedal, all notes played on the keyboard have a soft effect.

MIDI IN/OUT Jack

MIDI stand for Musical Instrument Digital Interface.

MIDI is a world wide standard that makes it possible for various electronic musical instruments and other devices.

MIDI IN:

Data transmitted from other MIDI instrument via MIDI is received by this terminal.

MIDI OUT:

Data produced by the Digital Piano is transmitted to other MIDI instruments via MIDI from this terminal.

USB Jack

Connect PC or other USB host devices that support USB Audio.

You can simply connect the PC and the piano with a USB cable. For PC that has installed Windows XP, the USB driver for the piano would be automatically installed as a USB Audio Device. After the PC informed you that the driver for the piano has been properly installed, you can choose the USB Audio Device in the audio device menu of the control panel or the MIDI software you are using to transfer MIDI data to the piano.

Note: USB connection can only be detected with Windows XP and Vista

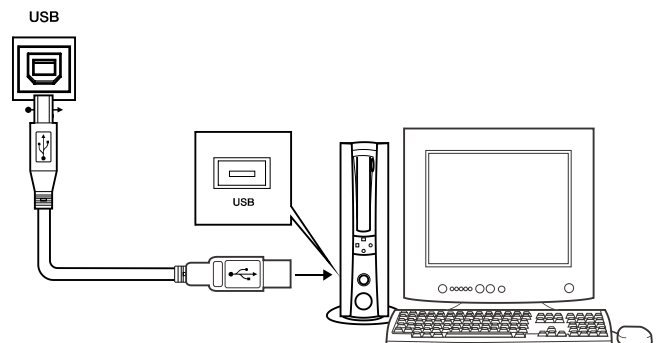
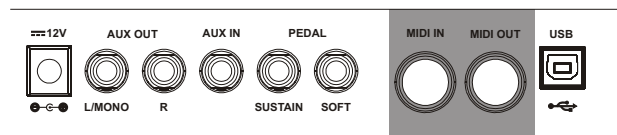
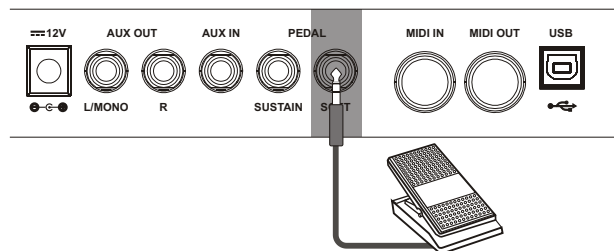
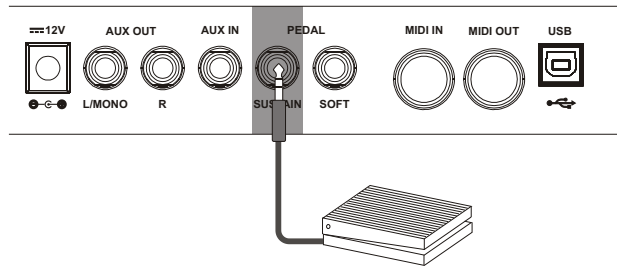
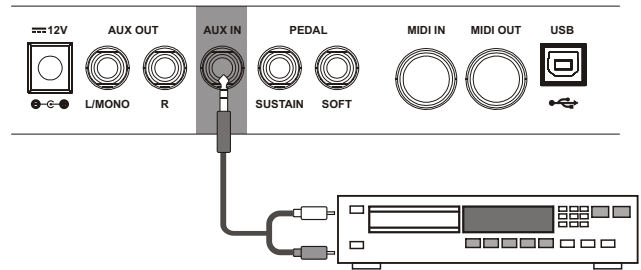

Power on & Master Volume

- 1 i Press the **[POWER]** switch. The LED display lightens up.
- 2 i Slide the **[VOLUME]** bar rightwards, the whole volume increase, slide it leftwards, the whole volume decreases.
- 3 i Press the **[+]** and the **[-]** button synchronously, and then power on the piano. it can reset all the setting to the default value and erase the record data.

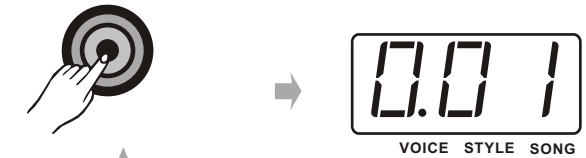

Press the power switch on

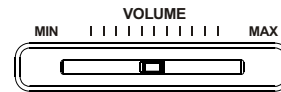

The level decreases

The level increases

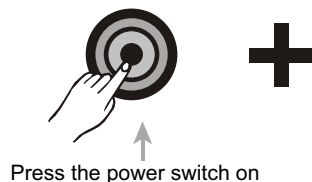

Press the power switch on

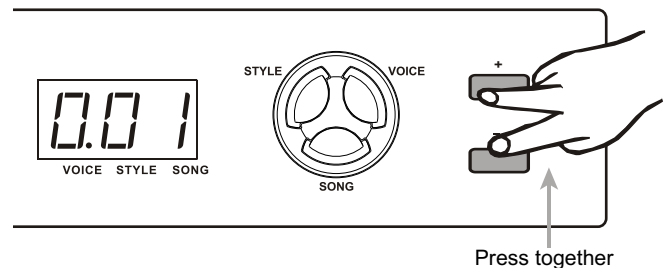

Press together

NOTE:

- If the LED display has not lightened up after you power on the piano, please check the power supply.
- If the piano is silent, the volume may be adjusted to its minimum level.
- Although Mains switch is in OFF position, the piano is not disconnected from the power supply completely!

Song

There are 60 songs in total. (See Appendix 3).

1 i PLAY a song:

Press the **[SONG]** button to enter the song mode, the **SONG** flag on LED is lightened. It will play all songs repeatedly in a cycle.

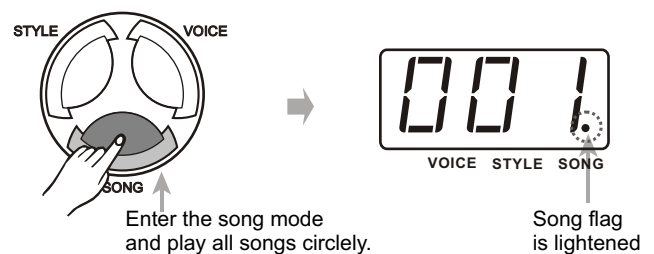

Enter the song mode and play all songs circularly.

Song flag is lightened

Press the **[START/STOP]** button to stop playing the song, but it will not quit the song mode. The 2nd time you start playing the song by pressing the **[START/STOP]** button, it will play current song repeatedly.

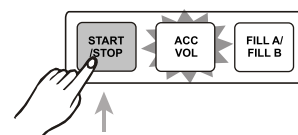

Press first to stop playing the song, press again to play current song repeatedly.

2i SELECT a song:

Use the **[+]** or **[-]** button to select the song you want. If you select the new song, LED will display it's number at first and then display introductory beat and the measure count.



The beat LED indicators are lightened in turn.

Select a song

3i INTRODUCTORY BEAT:

After pressing **[START/STOP]**, the measure count begins from negative value to 1, and then begins to play the song.

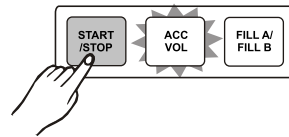

Display the measure count

4i Press the **[TRACK1]** button to enter self-learning mode, and turn on/off the main melody of the song.

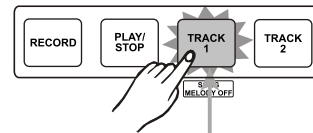

The LED indicator is lightened.

5i While the song stop playing, you can press the **[VOICE]** and the **[STYLE]** button to exit.

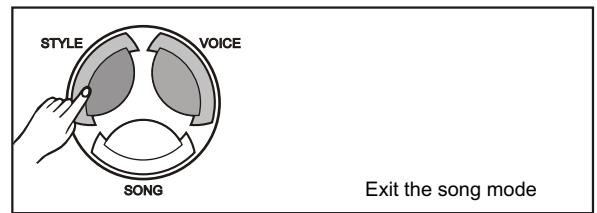

Exit the song mode

Voices and Effects

There are 20 voices in total (See Appendix 1).

Voice Select

- 1i When power is on, LED lightens the **VOICE** flag and displays the 001 voice number.
- 2i Press the **[VOICE]** button to enter the voice mode, LED displays the **VOICE R1** number.
- 3i Press the **[DUAL]** button to enter the dual voice mode, LED displays the **VOICE R2** number.
- 4i you can select other voice by pressing the **[+]** and the **[-]** or voice Direct Select buttons.

• Use Direct Select buttons to select

There are 10 voices Direct Select buttons to select 20 voices. Each Direct Select button can be used to choose 2 different voices.

Press the first time to select upper layer voice, press the second time to select the lower layer voice.

When you select the upper layer voice, the upper layer indicator turns on.

When you select the lower layer voice, the lower layer indicator turns on and the upper layer indicator turns off.



Display VOICE R1

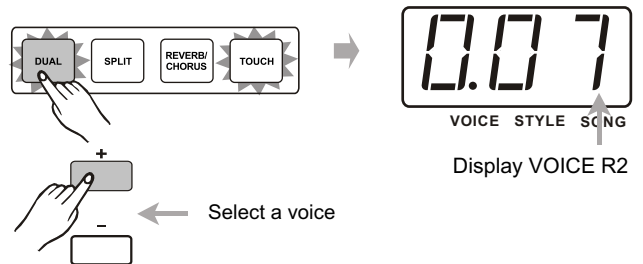

Display VOICE R2

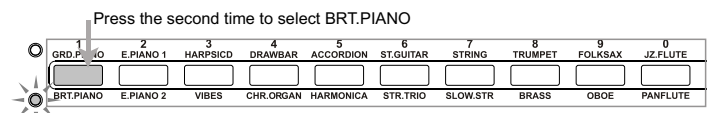
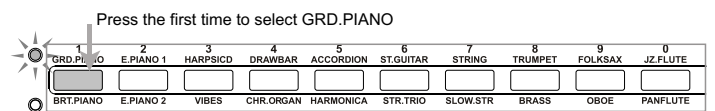

Dual

The piano has dual voice. You can create the new sound through this function for richer and punchier sounds. you can get two different sounds at the same time when pressing one key in the right area in the keyboard.

- 1i Press the **[DUAL]** button to turn on the DUAL mode, the **VOICE** flag on the LED and the indicator are both lightened. The dual voice number is also displayed on the LED.
- 2i Then, you can get two different sounds at the same time when you press one key on the keyboard.
- 3i Use the **[+] / [-]** button and voice Direct Select buttons to select your desired voice. The default voice number is 007.
- 4i Press the **[DUAL]** button again to turn off the DUAL mode, the indicator goes off.

NOTE:

While the keyboard is in split mode, only the right hand area can respond the dual voice, the left hand not below split point would respond.

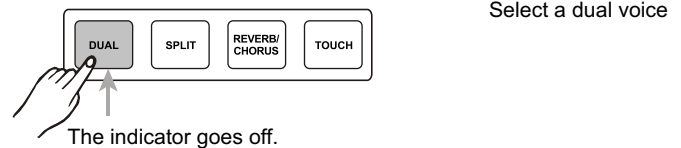
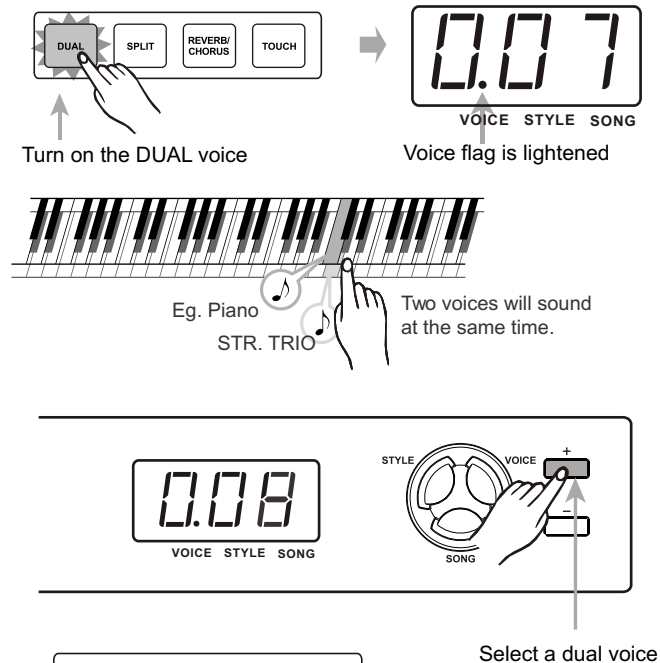

Split Point

You can split the piano to melody and chord area by this function.

- 1i Press the **[SPLIT]** button, LED displays the current split parameter XXX.
- 2i Use the **[+] / [-]** button or Keyboard to change it, after exit the setting mode the new value becomes to the new split point, the split default value is 34.
- 3i The new split point belongs to the left area of the keyboard.

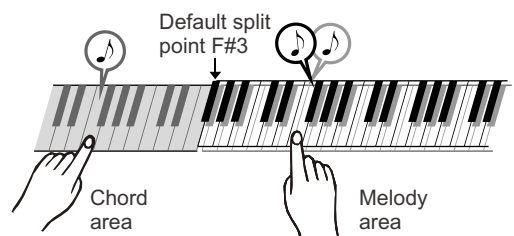
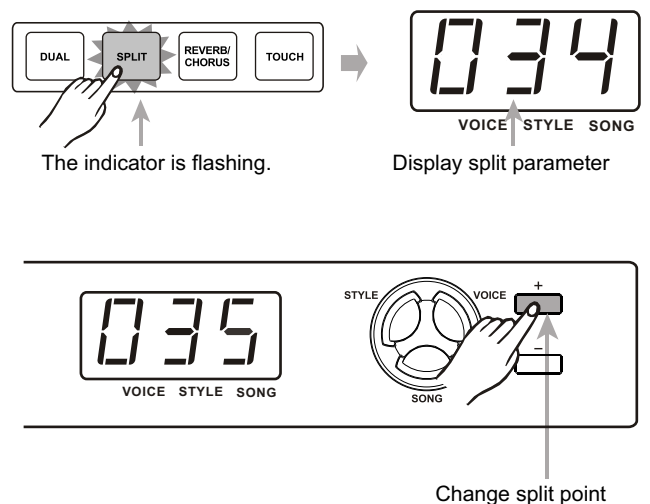

Transpose

- 1 i You can change the pitch of the entire keyboard by semitone steps with TRANSPOSE function.
- 2 i Press the [TRANSPOSE +] or [TRANSPOSE -] button for the first time, LED displays current transpose value temporarily.
- 3 i Press [TRANSPOSE +] to increase the value and Press [TRANSPOSE -] to decrease the value, the maximal range to be adjusted is from -12 to +12 semitones, the default value is 000.
- 4 i In TRANSPOSE setting, press the [TRANSPOSE +] and [TRANSPOSE -] button simultaneously to set the value to default.

NOTE:

If you don't press any button for 2 seconds in transpose setting mode, it will quit this mode automatically.

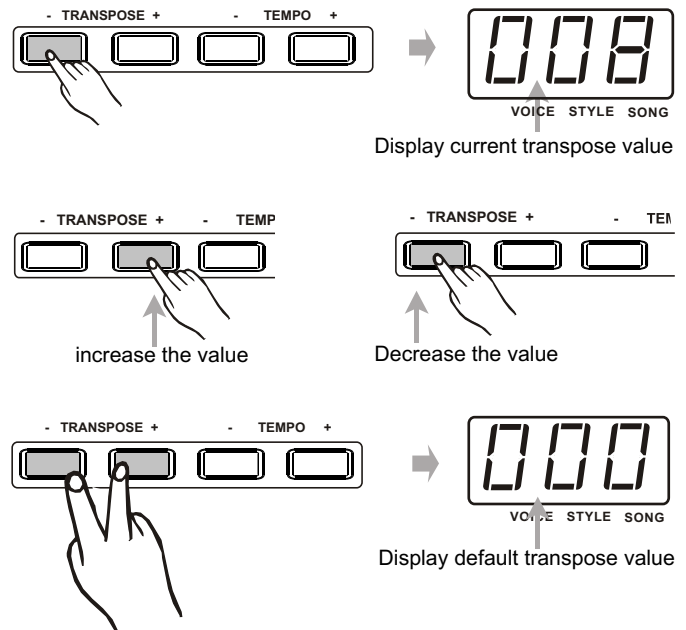

Touch

This function allows you to turn on the dynamic level when playing the keyboard.

- 1 i When power is on, the TOUCH indicator lightens. Press the [TOUCH] button continuously to select the touch response type, the TOUCH indicator flashes and displays touch response type 00X temporarily on LED.
- 2 i There are 4 touch response types. Press [TOUCH] button repeatedly to select, the default is 002.
- 3 i If the type is set as OFF, it means no touch response to keyboard, the TOUCH indicator goes off.

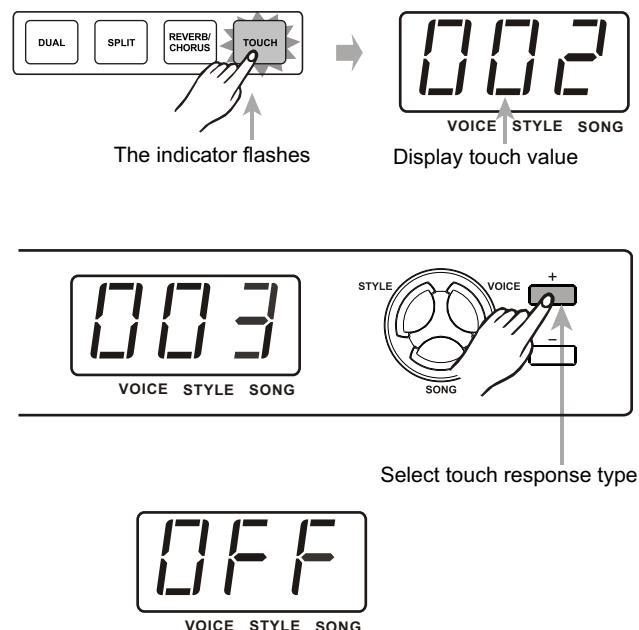

NOTE:

If you don't press any button for 2 seconds in touch response type select mode, it will quit this mode automatically.

Reverb/Chorus

Reverb/chorus effect will enhance the piano with fuller and expressive sound.

- 1 When power is on, the **Reverb/chorus** indicator is on.
- 2 Press the **[REVERB/CHORUS]** button to switch the DSP response setting.
- 3 Press **[REVERB/CHORUS]** repeatedly to switch to reverb or chorus setting mode.
- 4 There are 32 levels to be selected by pressing **[+]** and **[-]** buttons. The default chorus level is 00, the default reverb level is 08.

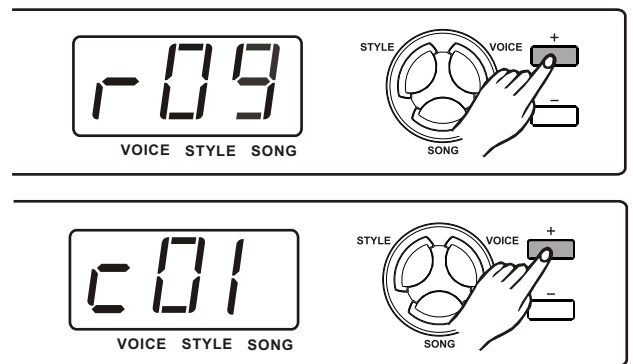
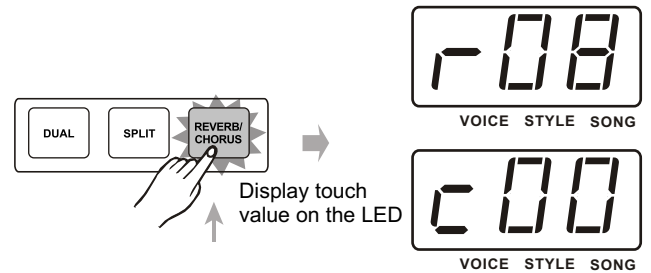

Brilliance

When the piano is power on:

Push **[BRILLIANCE]** slider bar to right, it sounds brighter;

Push **[BRILLIANCE]** slider bar to left, it sounds more gloomy;

You can change the piano brilliance as your wish.

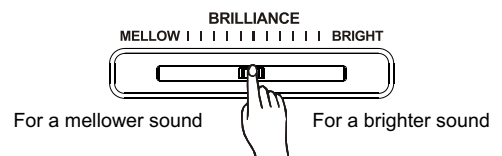

Scale

This function allows you to experience different scales when you play certain genres of music that is not composed based on twelve equal interval.

1 i Press **[SCALE]** button to enter into scale mode and the button indicator lights up; The default scale is 001 Pythagor.

2 i There are 6 types of scale to select:
Pythagor, Major, Minor, Meantone, Werckmei, Kirnberg.

3 i Press **[SCALE]** button again to exit scale mode and the button indicator goes off.

4 i Hold and press **[SCALE]** for 2 seconds to enter into SCALE select status. The scale now flashes and the scale number displayed on LED.

5 i Use **[+]** or **[-]** to select the scale type, play the key from C7~B7 to select scale root.

- For Example, to select the scale named "Minor" and set the root key to "G", Press "+" till "003" is displayed on the LED, then press the G7 key for 3 seconds to set the root, LED displays "G", "G" stands for "Scale Root".

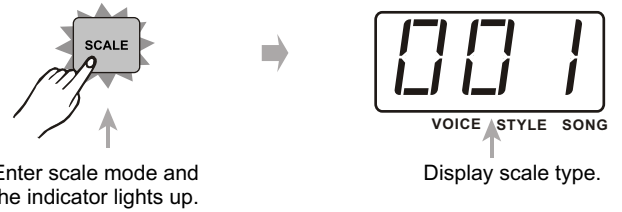

Types of scale :

Number	Name	Number	Name
1	Pythagor	4	MeanTone
2	Major	5	Werckmei
3	Minor	6	Kirnberg

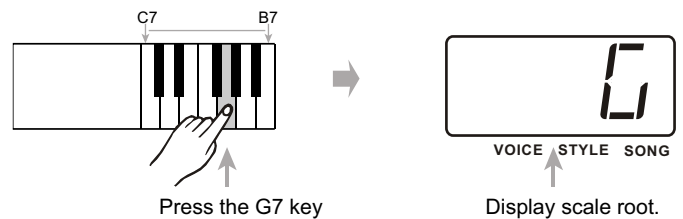
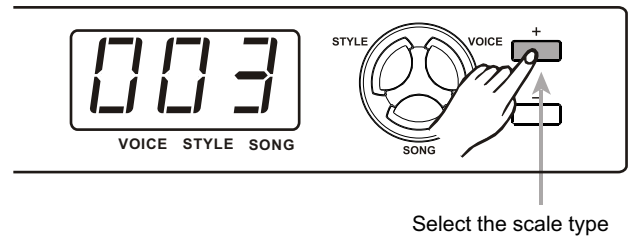
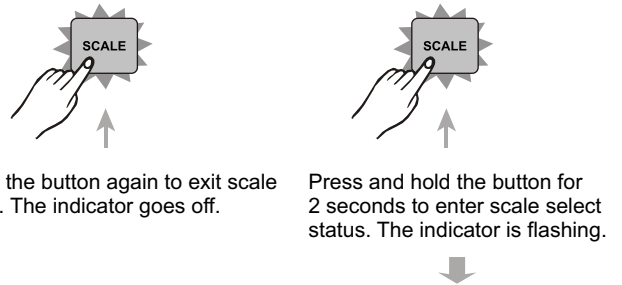

Metronome

- 1 i Press the **[METRO]** button to turn on the metronome and the metronome sound will be played.
- 2 i Press the button again to turn off the metronome.
- 3 i When the style stops to play, the beat type follows 4/4 after turning on the metronome. When the style begins to play, the beat type follows the current style.
- 4 i Metronome can be turned on together with the style. If the style plays at first, then to turn on the metronome, the metronome will respond next measure. If the metronome plays at first, then to start to play the style, the metronome responds at once to the first beat of the style.

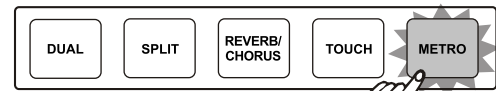

The LED indicator is lightened.

Metronome can be turned on together with the style.

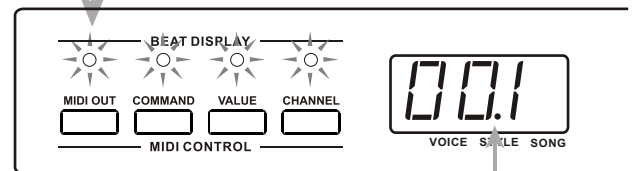

The beat LED indicators are lightened in turn.

Style Control

There are 20 styles in total. (See APPENDIX 2).

STYLE SELECT

- 1 i Press the **[STYLE]** button to enter style mode, the style number and style flag on the LED are both lightened.
- 2 i You can use the **[+]** / **[-]** button to select the style you want.

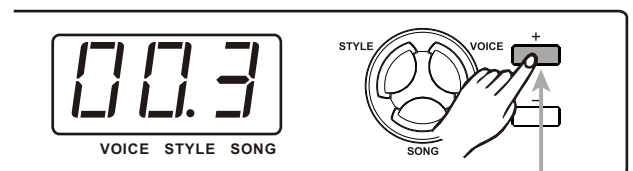

Start/Stop The Style

- 1 i When the style is not playing, you can press the **[START/STOP]** button to enter "SYNC START" mode, the beat point are flashing at the same time, now the style will be start with A.B.C. on if you press the key in the chord area on Piano.
- 2 i Press the **[START/STOP]** button again to stop style play and turn off the A.B.C. function at the same time.

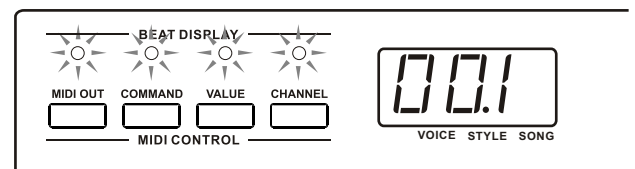
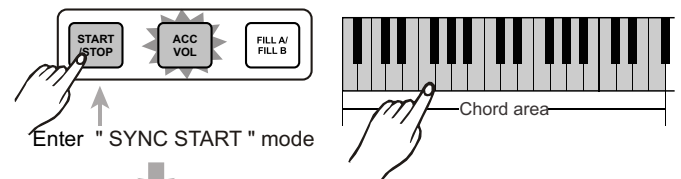

The beat LED indicators are flashing at the same time.

FILL IN A/B

- 1 i In **NORMAL** mode, press the **[Fill A / Fill B]** button to insert 1 measure fill and the **Fill A / Fill B** indicator is flashing, after one measure is over, **VARIATION** Style will be returned.
- 2 i In Variation mode, press the **[Fill A / Fill B]** button to insert 1 measure fill and the **Fill A / Fill B** indicator is flashing, after onemeasure is over, **NORMAL** style will be returned.
- 3 i When power is on, the preset style mode is **NORMAL** mode.

Accomp Volume

- 1 i Press the **[ACC VOL]** button, LED displays the current volume temporarily.
- 2 i You can use the **[+] / [-]** button to adjust the volume from 0 ~ 31. (Default Accomp Value is 24) The **ACC VOL** indicator is flashing at the same time.
- 3 i When power is on, the **ACC VOL** indicator is on.
- 4 i In **ACC VOL** mode, press the **[+] and [-]** buttons synchronously can mute the accompaniment, the **ACC VOL** indicator goes off at the same time; If you press the **[+] and [-]** buttons again synchronously can open the accompaniment, the **ACC VOL** indicator is lightened at the same time.

Tempo

- 1 i Use the **[TEMPO+]** or **[TEMPO-]** button to adjust the tempo from 30 to 280.
- 2 i Press the **[TEMPO+]** and **[TEMPO-]** synchronously to set to the default tempo.
- 3 i When the style is not playing, it will take out the default tempo of the style if you select the style. When the style is playing, it will keep the current tempo once you change the style.

Style is not playing:



Preset style mode is **NORMAL** mode, the indicator is off.

Press and enter **VARIATION** mode, the indicator is on.

Style is playing:



The indicator is flashing, after a measure is over, the indicator is on, enter **VARIATION** mode.

The indicator is flashing, after a measure is over, the indicator is off, enter **NORMAL** mode.

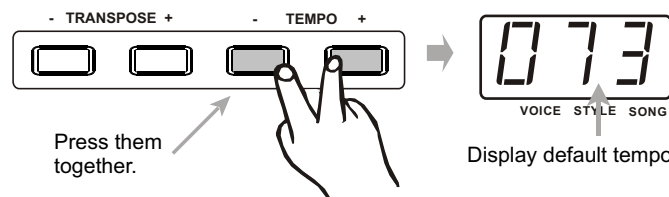
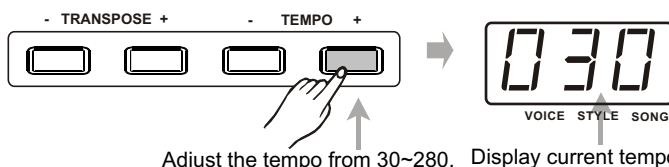
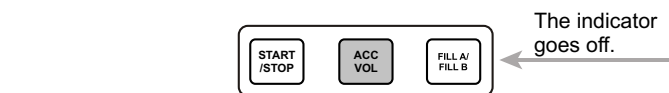
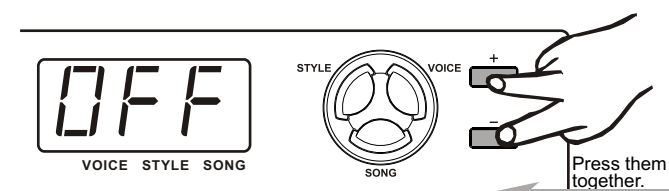
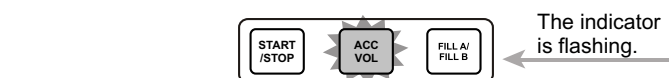
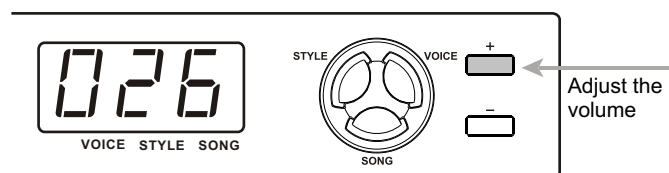

Record

There is one user song can be recorded, include 2 Melody Tracks.

Record Song

1 i Waiting for recording:

Press the **[RECORD]** button for the first time to enter the record mode.

- The **RECORD** indicator flashes, four beats flashes synchronously to indicate waiting for recording.
- At the same time an empty track will be selected to be recorded automatically and relative track flag flashes (the selection order is Track 1, Track 2, the Track 1 will be selected while neither the tracks is empty)
- You also can press the **[TRACK 1]** or **[TRACK 2]** button to select the track you want to record.

2 i Start recording:

- When 4 beats flashes on LED, you can play the keyboard directly to start recording, the **RECORD** indicator and track flag that you select both flashes.

- When 4 beats flashes, you can also press the **[START/STOP]** button, open the A.B.C. and start record.

Press the key in the left area and sync start style, then style data are recorded to the correspond track.

- If the two tracks all have style data, it will be overwritten by the new data.

3 i Stop recording:

- Press the **[RECORD]** button for the second time to stop recording. LED display and indicator get back to the previous mode.

- If the capacity is full while recording, the recording will be stopped automatically with the **FUL** display on LED.

NOTE:

The recorded data will not be lost when you turn off the power.
Hold on the **[+]** and **[-]** button together and power on the piano, it will erase all the recorded data.

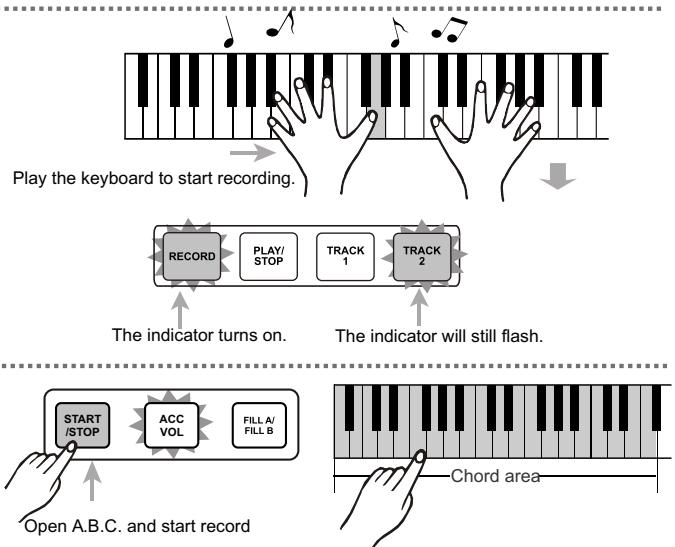
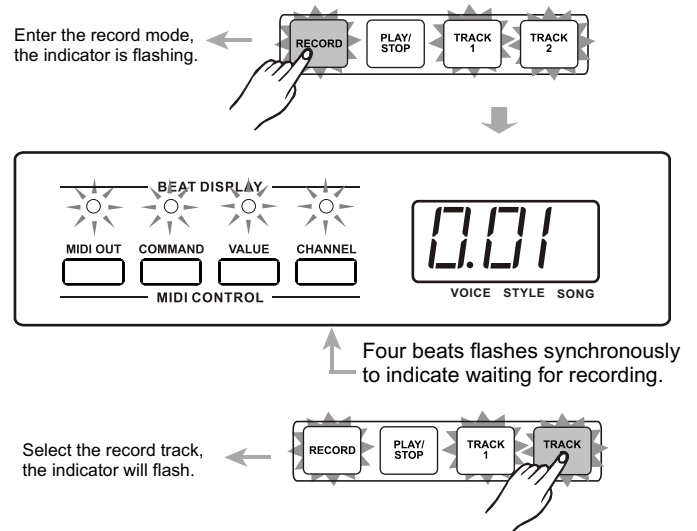

NOTE:

when entering record mode, the old data of the selected track will lost.

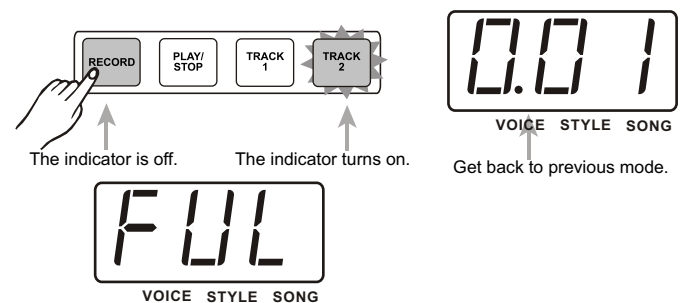

Playback Song

- 1i Press the **[PLAY/STOP]** button for the first time to playback the record data, you can choose any one track or all two tracks to play, the indicator is on.
- 2i Press it for the second time or press the **[START/STOP]** to stop playback.
- 3i You can press the **[TRACK 1]** and **[TRACK 2]** button to turn on or off the relative track in process of playback.

NOTE:

If there is no record data when you press **[PLAY/STOP]** LCD will display "NUL" temporarily. Press "+" and "-" together when power is on and the song data will be cleared.

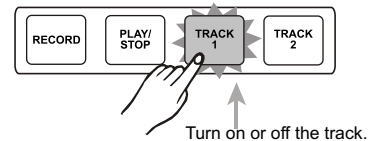
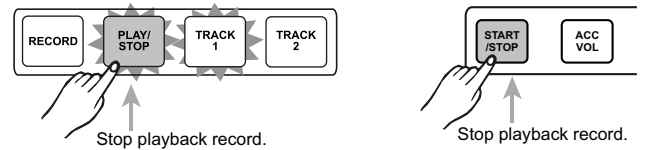
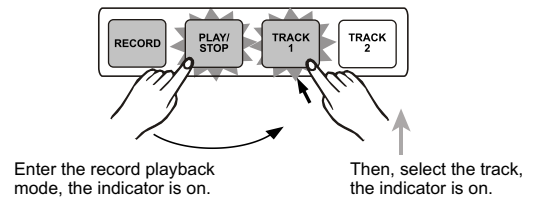

Lesson

- 1i In song mode, press the **[TRACK1]** button to enter the lesson mode.
- 2i When you press the **[TRACK1]** button, the **[TRACK1]** indicator turns on, it will mute the melody of the song, then you can play the Piano to practise the song you want.
- 3i Press **[TRACK1]** again and melody will save, the **[TRACK1]** indicator again goes off.

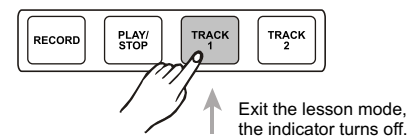
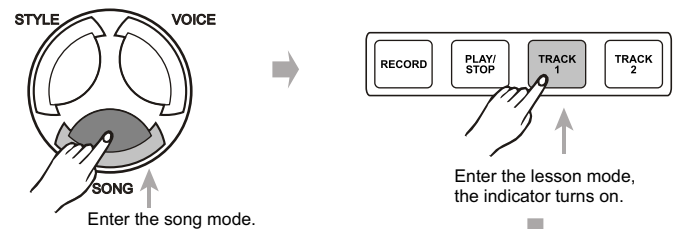

SD Function

There is a standard SD external interface which supports the cards of 16M ~ 2G capacity. It is compatible with the file system format of the FAT 16/32.

Press one of the 2 SD buttons **[PLAY]**, **[STORE]** to enter the relative function mode.

If there is no card, "ERR" will display 2 seconds.

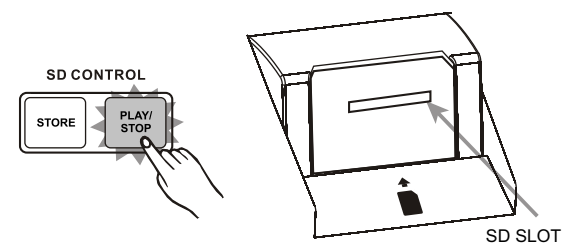

1i SD card function

- **PLAY** can play midi file at the root directory in SD, support format 0 and format 1.
- **STORE** can save the recorded data to SD root directory as midi file which can be played on MIDI player.

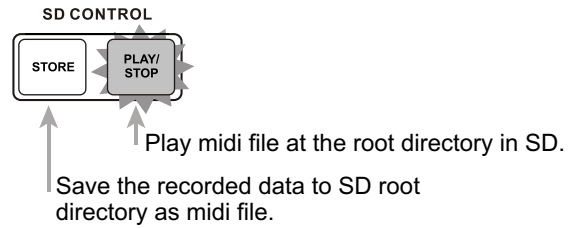

2i SD button

In the SD mode, it won't respond to the other button except **[VOICE]**, **[STYLE]**, **[SONG]**.

It can play MIDI file and save recorded data at the root directory.

• Play

When power is on, press the **[PLAY]** button to play all files at the root directory in SD card and the PLAY indicator is on.

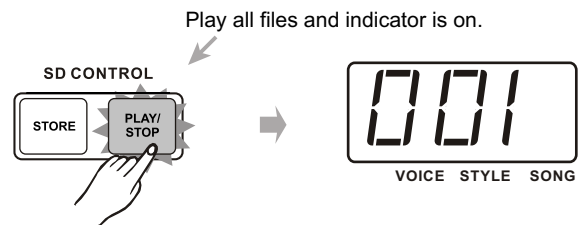

In the SD mode, you can select the midi file with **[+]** or **[-]** button. The default file number is 001.

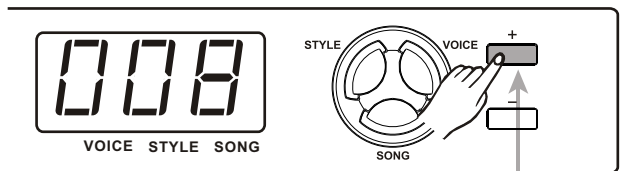

When playing the midi file, you can press the **[PLAY]** or the **[START/STOP]** button to stop playing.

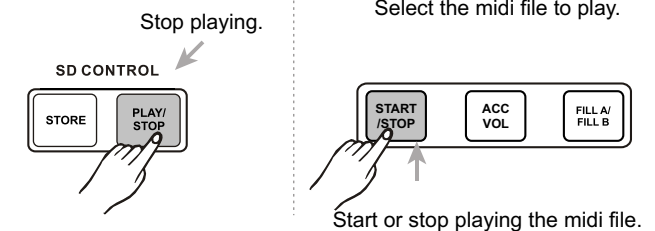

Press the **[START/STOP]** button again to start to play it repeatedly.

Press the **[PLAY]** button when there is no midi file in the SD card, LED display "noF", then the display will get back to previous mode in 2 seconds.

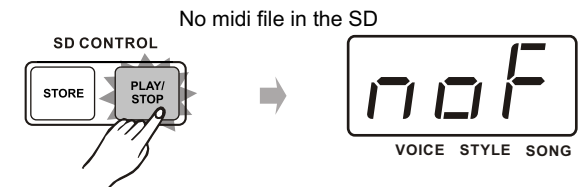

• Store

Please add the following in the "Store" Section, after "If the SD card capacity is full, it will stop saving automatically and display "Ful".Then exit the store mode and return to the previous mode."

If there's no MIDI files in the root directory of the card, "NoF" will display on the LED, meaning there's no recorded user song to be saved to the card.

If the card is write-protected, "Loc" will display on the LED.

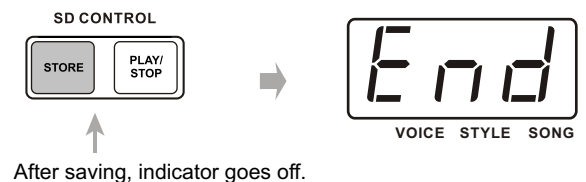
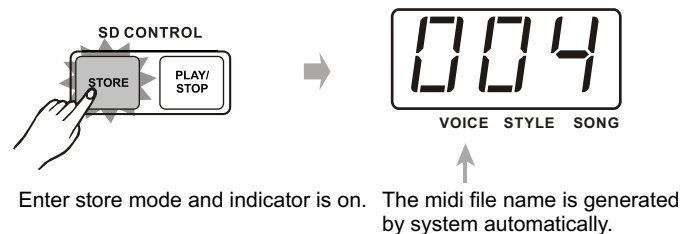

Midi Controller

Summarize

Under MIDI controller mode, other buttons all have no effect except four MIDI controller, [+]/[-] numeric button, the VOICE/STYLE/SONG button.

When power on the piano, press one of the [COMMAND], [VALUE], [CHANNEL] and [MIDIOUT] MIDI controller to enter into MIDI controller mode. When in other mode, press the [MIDIOUT] button to send out a set of default midi control command.

Press the [VOICE] / [STYLE] / [SONG] button, can exit the MIDI controller mode, return to voice, style or song mode.

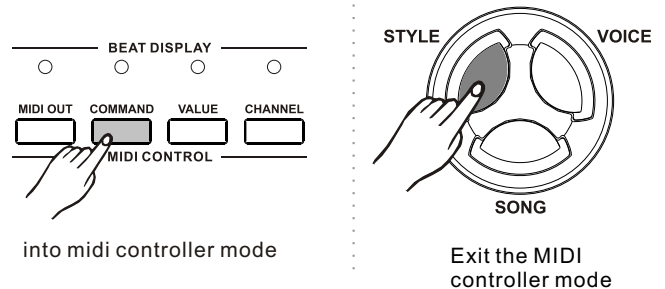

Command

Press this button, the command indicator is on, you can choose the related command by pressing the [+]/[-] or numeric button.

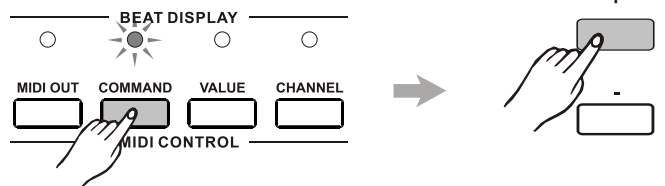

MIDI OUT

Press this button, the MIDIOUT indicator turns on and it send out a set of midi control command, the indicator flashes in the process of sending out, when it finish sending out, the indicator go off.

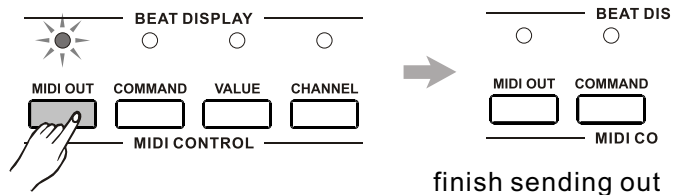

Value

Press this button, the value indicator is on, you can set the value by pressing the [+], [-] or numeric button.

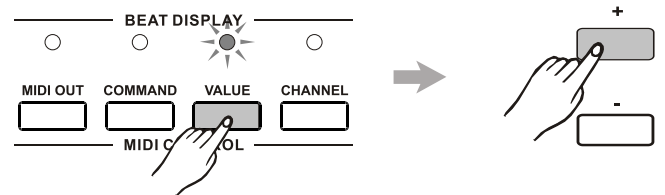

Channel

Press this button, the channel indicator is on, you can select any channel that you want from 1-16 by pressing the [+], [-] or numeric button.

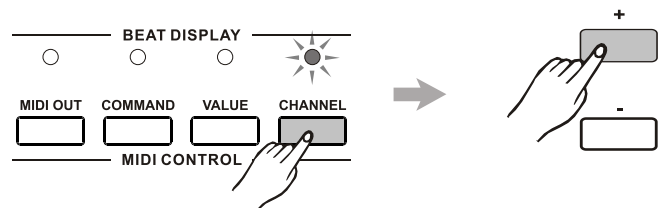

Command

1. When the button is pressed, the indicator of the button lights.
2. The LED display 001 (default command), you can select MIDI CTRL information by the numeric button, the [+] button or the [-] button and ;XXX; will displayed on LED. You can set 131 MIDI command (0 £130), the default number is 1.

number	command
0_127	standard MIDI control(BN)
128	program change(CN)
129	channel pressure(DN)
130	pitch bend(EN)

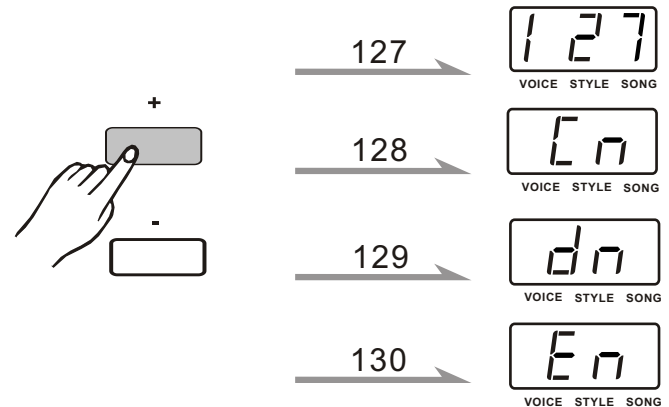
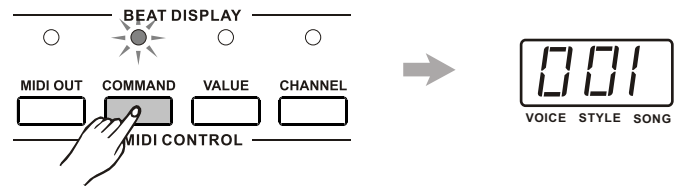

3. The command you select is shown on the LED. (Once you set 128, "Cn" will be displayed, you set 129, "Dn" will be displayed, you set 130, "En" be displayed), you can select number allowed circularly by pressing the [+] button or the [-] button; While setting number with the numeric button, after you press the first number, the command indicator flashes and wait for press the second number, finish pressing the second, if still allow press the third number, the indicator continues to flash, waiting for press the third number, when you finish pressing the third number, it will stop flash. If you does not press any button in 2 seconds, it will exit the number setting status automatically.

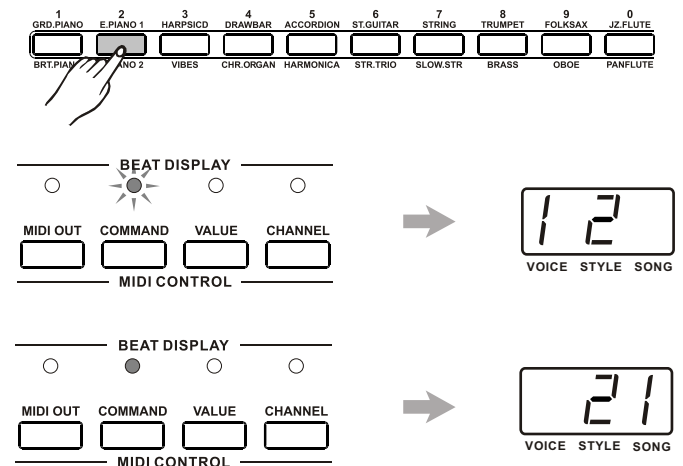

- If the number you set is from 0 _127, that represent as the DATA1 of Bn order, and the value of DATA2 can be set by pressing [VALUE] button.
- If the number you set is 128, that means Cn command be selected, the value of DATA can be set by pressing the [VALUE] button.
- If the number you set is 129, that means Dn command be selected, the value of DATA can be set by pressing the [VALUE] button.
- If the number you set is 130, that means En command be selected, the value of DATA can be set by pressing the [VALUE] button.

When the value you set is 0H, that means to bend the note down to the lowest,
When the value you set is 40H, that means to bend the note to the normal value;

- In COMMAND mode, press the [VALUE]/[CHANNEL] button to enter into VALUE and CHANNEL setting mode, corresponding button indicator turn on, the COMMAND indicator go off.
- If you press the [MIDIOUT] button, it will enter into midiout mode and send out midi control message.
- Press the [COMMAND] button continuously to select the next command type (as follows).

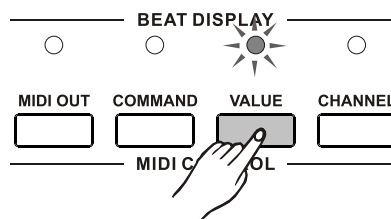

NO.	Adjust digit value	Display (default)	Command type name
1	0-127	001	Bn
2	128	Cn	Cn
3	129	Dn	Dn
4	130	En	En

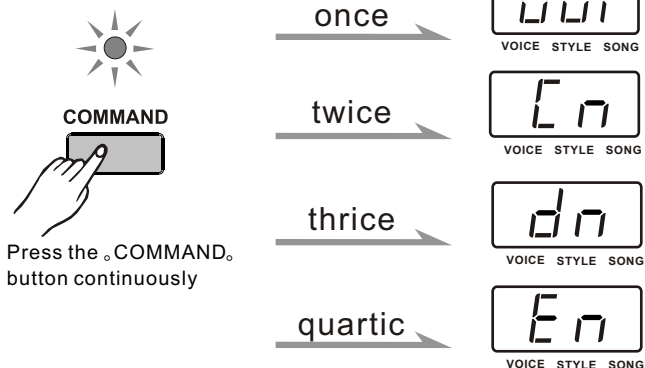

Press the .COMMAND. button continuously

Channel

- The button is used to choose the MIDI CTRL channel, from:1~16.
- Pressing this button to get into CHANNEL setting mode, the LED display the current default channel value XX, the CHANNEL button indicator light up.
- Use the [+] button, the [-] button or numeric button to choose CHANNEL.
 - You can choose channel allowed circularly by pressing the [+] or the [-] button.
 - You can also set channel with the numeric button, after press the first number, channel indicator flashes and wait for press the second number, when you finish pressing the second number, it will stop flash. If you does not press any button in 2 seconds, it will exit the number setting status automatically.
- If you press the [COMMAND] button or [VALUE] button, it will get into correspond mode, and the indicator of the corresponding button indicator turn on, the CHANNEL indicator go off.
- If you press the [MIDIOUT] button, it will get into midiout mode.

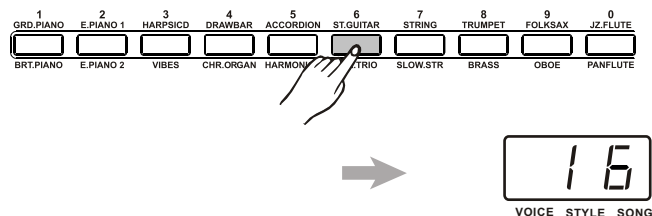
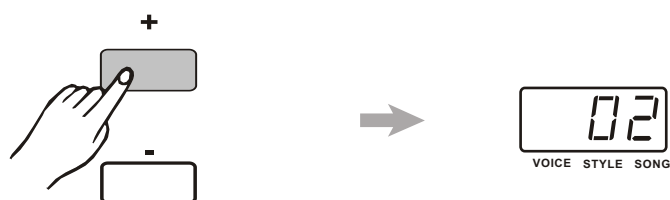
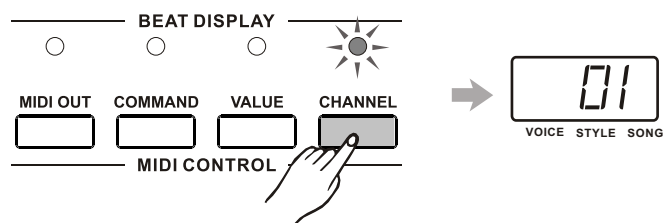

Value

1. Press this button to enter into VALUE setting mode, the indicator is on, the LED will show the default VALUE as 064.
2. Use the [+] button, the [-] button or numeric button to set VALUE value from 0 to 127. you can set value allowed circularly by pressing the [+] button or the [-] button . you can also set value with the numeric button, after you press the first number, the value indicator flashes and wait for press the second number, finish pressing the second, if still allow press the third number, the indicator continues to flash, waiting for press the third number, when you finish pressing the third number, it will stop flash. If you does not press any button in 2 seconds, it will exit the number setting status automatically.
3. If you press the [COMMAND] button or the [CHANNEL] button, it will get into correspond mode and its button indicator turn on, the VALUE indicator go off.
4. If you press the [MIDIOUT] button, it will get into MIDIOUT mode.

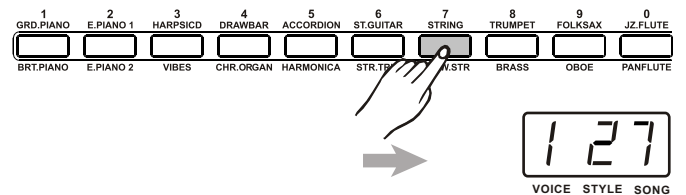
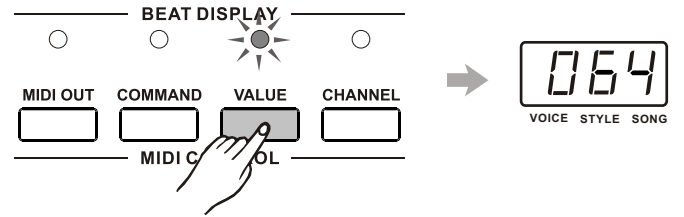

MIDI OUT

Press [MIDIOUT] button to sent out a set of MIDI control message.

1. Press this button, the indicator of that button flash within 2 seconds, when finish sending out MIDI CONTROL message, the indicator go off.
2. Press this button doesn't change current mode after sending out MIDI CONTROL Message. Continuous pressing the [MIDIOUT] button, it will send out same MIDI CONTROL message.

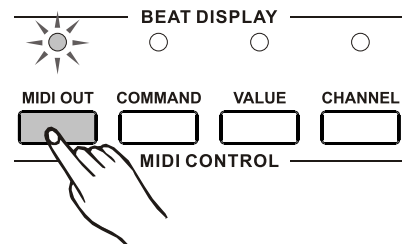

What is MIDI

- 1i Musical Instrument Digital Interface. The standard interface between PC and Electronic instrument.
- 2i It is equipped with standard MIDI interface, including 1 MIDI IN and 1 MIDI OUT.
- 3i Connection
It can connect with PC or other MIDI equipment.

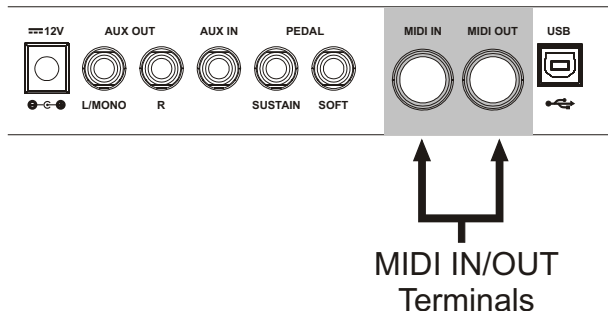

MIDI Connection

1i Connection rule

In midi connection, the equipment which controls another equipment is called Host Equipment. Another equipment is called Affiliated Equipment. The host equipment's MIDI OUT connect with affiliated equipment's MIDI IN. Do not connect MIDI OUT with MIDI IN on the same equipment.

2i MIDI IN

You can use a MIDI cable to connect the MIDI IN terminal of system to another MIDI OUT terminal of compatible MIDI electronic instrument. Use MIDI IN, system can receive midi data such as note, program and touch etc. in order to be handled by another MIDI instrument.

MIDI OUT

You can use a MIDI cable to connect the MIDI OUT terminal of system to another MIDI IN terminal of compatible MIDI electronic instrument. Midi data of system can be sent by MIDI OUT, when a note is generated, the relative message will be transmitted. System can control other midi instrument by sending program change messages

3i Sample Connection Method

Connect the MIDI interface with your PC.

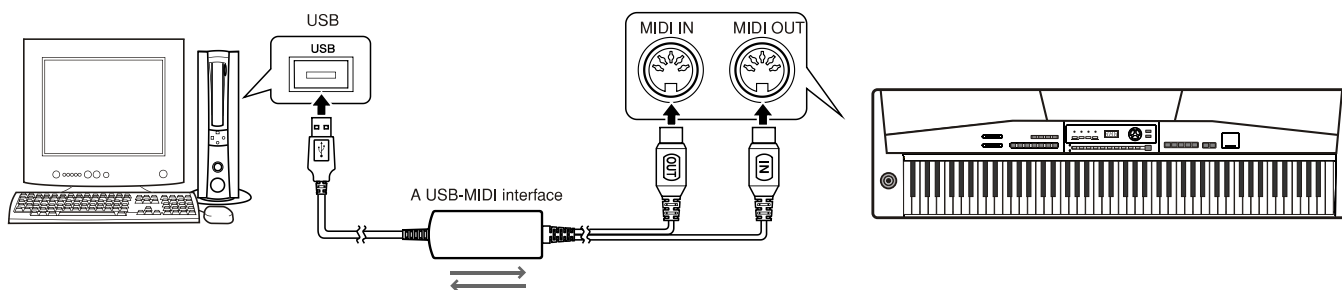

Connect the MIDI interface with other digital music instruments.

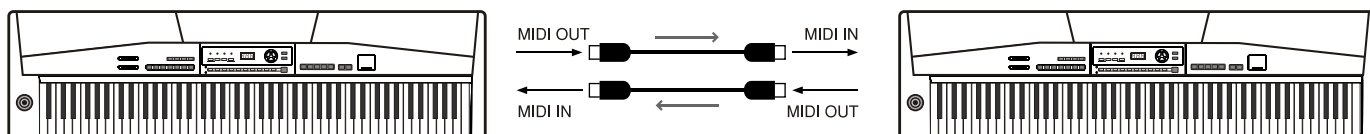

Major Application

- 1i The piano can control other equipments or electronic instruments.
- 2i Some equipments can be used to control the piano.
- 3i PC recorded data (MIDI) can be played on the piano.

Specifications

Keyboard	88 keys, 3 kinds of touch level.
Voice	20 voices.
Style	20 piano styles.
Song	60 songs.
Display	LED display.
Switch and Buttons	POWER SWITCH, VOLUME SWITCH, DUAL, REVERB/CHORUS, TOUCH, RECORD, TRACK 1, TRACK 2, PLAY/STOP, SPLIT, METRO, TRANSPOSE +/-, TEMPO +/-, SD CONTROL, SONG, VOICE, STYLE, BRILLIANCE, MIDI OUT, COMMAND, VALUE, CHANNEL, SCALE, START/STOP, ACC VOL, FILL A/FILL B
Transpose	±12 semi tones
Pedals	Soft, Sustain
Connectors	AC POWER, HEADPHONES, AUX IN/OUT, MIDI IN/OUT, PEDALS, USB
Dimension	1360(L)x370(W)x143(H)mm
Weight	19.5kg

Appendix 1 - Voice List

No	PRG	BANK	Name of Voice	Name of Voice on Panel
001	0	0	Acoustic Grand Piano	GRDPIANO
002	4	8	Epiano1	EPIANO1
003	6	0	Harpsichord	HARPSICD
004	16	0	Hammond Organ	DRAWBAR
005	21	0	Accordion	ACORDION
006	25	8	Steel Guitar	STGUITAR
007	48	8	String	STRING
008	56	8	Trumpet	TRUMPET
009	66	8	Folk Sax	FOLK SAX
010	73	0	Jazz Flute	JZ.FLUTE
011	1	0	Bright Acoustic Piano	BRTPIANO
012	5	8	Epiano2	EPIANO2
013	11	8	Vibes	VIBES
014	19	0	Church Organ	CHRORGAN
015	22	0	Harmonica	HAMONICA
016	40	8	STRTRIO	STRTRIO
017	49	0	Slow String	SLOWSTR
018	61	0	Brass Section	BRASS
019	68	0	Oboe	OBOE
020	75	0	Pan Flute	PANFLUTE

Appendix 2 - Style List

No	Name of Style
001	Pianist
002	8 Beat
003	16 Beat
004	Ballad
005	Pop Piano
006	Boogie
007	Slow Rock
008	Swing
009	Jazz
010	Jazz Waltz
011	Swing Fox
012	Shuffle
013	Twist
014	Country Ballad
015	Bossa Nova
016	Latin
017	March
018	6/8 March
019	Waltz
020	Slow Waltz

Appendix 3 - Song List

No	Name of Song
Piano	
001	For Alice
002	Habanera
003	Four Little Swans
004	Moseta Dance
005	Germanic Dance
006	Turkish March
007	March
008	Away In A Manger
009	Chopsticks
010	2-Part Invention #13 In A Minor.B.W. lli
Folk & Country	
011	Country
012	Jambalaya
013	Susanna
014	Bridge
015	Battle Hymne Of The Republic
016	The Old Gray Mare
017	American Patrol
018	In The Rain
019	Sippin`Cider Through A Straw
020	Are You Lonesome Tonight
Golden & Pop	
021	Only You
022	End Of The World
023	House Of Rising Sun
024	The Blue-Bells Of Scotland
025	Over The Rainbow
026	Beautiful Dreamer
027	Edelweiss
028	O Sole Mio
029	Silent Night
030	Ave Maria

No	Name of Song
031	Five Hundred Miles
032	Happy New Year
033	It`S Beginning To Look A Lot Like Christmas
034	Jeanie With The Light Brown Hair
035	My Bonnie
036	Song Of The Pearlfisher
037	The Stage Coach
038	Entertainer
039	Annie Laurie
040	Killing Me Softly With His Song
041	Last Rose Of Summer
042	The Old King Cole
Jazz & fusion	
043	Maple Leaf Rag
044	June Samba
045	Funk
046	I Can.....
047	Sea Shore
048	Guitar&Saxphone
049	The Hip Hop's Night
050	Blue Lunch
051	Cobweb
052	Wine
053	Jazz Old Man
054	Dark Eyes
055	Carlos
056	Sad
057	The Jazz
Chinese	
058	South Mud Bay
059	Give You A Rose
060	Flowing Rill

MIDI Implementation Chart

Function		Transmitted	Recognized	Remarks
Basic Channel	Default Changed	1ch 1-16ch	1-16ch 1-16ch	
Mode	Default Messages Altered	i i *****	3 i i	
Note Number :	True voice	09-120 *****	0-127 0-127	
Velocity :	Note on Note off	© 9nH,V=1-127 i £ 9nH,V=0	© 9nH,V=1-127 i (9nH,V=0; 8nH,V=0-127)	
After Touch	keyis Chis	i i	i ©	
Pitch Bend		i	©	
Control Change	0 1 5 6 7 10 11 64 65 66 67 80 81 91 93 120 121 123	i i i i i i i i i i i i i i i i i	i i i i i i i i i i i i i i i i	Bank Select Modulation Portamento Time Data Entry Volume Pan Expression SustainPedal Portamento on/off SostenutoPedal Soft Pedal ReverbProgram ChorusProgram ReverbLevel ChorusLevel All Sound Off Reset All Controllers All NotesOff
Program Change :	true #	i *****	i 0-127	
System Exclusive		i	i	
System Common	£Song Position £Song Select : Tune	i i i	i i i	
System Real Time	: Clock : Commands	i i *1	i i *1	
Aux	:LOCAL ON/OFF	i	i	

MIDI Implementation Chart

Aux :LOCAL ON/OFF :ALL NOTES OFF Messages :Active sense :Reset	i i i	i i i	
	*1 When the accompaniment is started, an FAH message is transmitted. When accompaniment is stoped, an FCH message is transmitted. When an FAH message is received, accompaniment is started. When an FCH message is received, accompaniment is stoped.		

Mode 1: OMNI ON , POLY Mode 2 : OMNI ON , MONO ♯ : YES
 Mode 3: OMNI OFF , POLY Mode 4 : OMNI OFF , MONO ◦ : NO

